

1. Mechanical Dimensions:

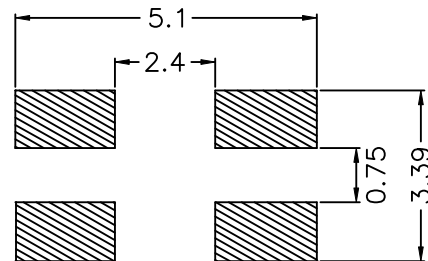

Suggested PCB Layout

2. Schematic:

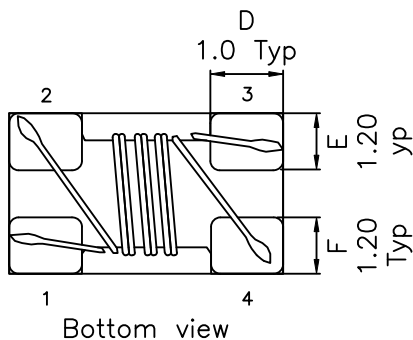
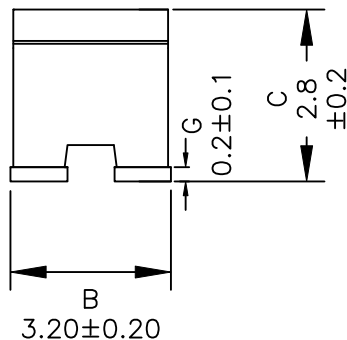
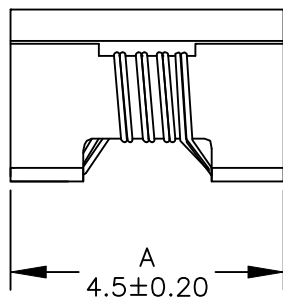
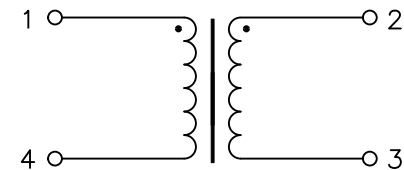

3. Electrical Specifications: @25°C

Common Mode Impedance: 1000 Ohms Min,
2000 Ohms Typ @10MHz
OCL: $51.0\mu\text{H} \pm 50\% / -30\%$ 100KHz, 0.1V each wdg
DCR: 1.00 Ohms Max each
Rated Current: 230mA dc Max
Rated Voltage: 50Vdc Typ
Insulation Resistance: 10 MOhms Min.

Notes:

1. Solderability: Leads shall meet MIL-STD-202G, Method 208H for solderability.
2. Flammability: UL94V-0
3. ASTM oxygen index: $> 28\%$
4. Insulation System: Class F 155°C. UL file E151556
5. Operating Temperature Range: All listed parameters are to be within tolerance from -40°C to $+125^\circ\text{C}$
6. Storage Temperature Range: -40°C to $+125^\circ\text{C}$
7. Aqueous wash compatible
8. SMD Lead Coplanarity: $\pm 0.004'' (0.102\text{mm})$
9. Electrical and mechanical specifications 100% tested
10. RoHS Compliant Component
11. Recommended IR Reflow peak temp of 250°C Max.
12. AEC-Q200 Certified Product

XFMRS® www.XFMRS.com		Title: Common Mode Choke	
UNLESS OTHERWISE SPECIFIED TOLERANCES: .xx ± 0.25 Dimensions in MM	P/N: XFWCMC4532A-510		REV. A
	DWN.	Yuan	Jul-16-20
	CHK.	YK Liao	Jul-16-20
	APP.	TCH	Jul-16-20
SHEET 1 OF 2			

DOC. REV: A/5

PROPRIETARY

Document is the property of XFMRS Group & is not allowed to be duplicated without authorization.

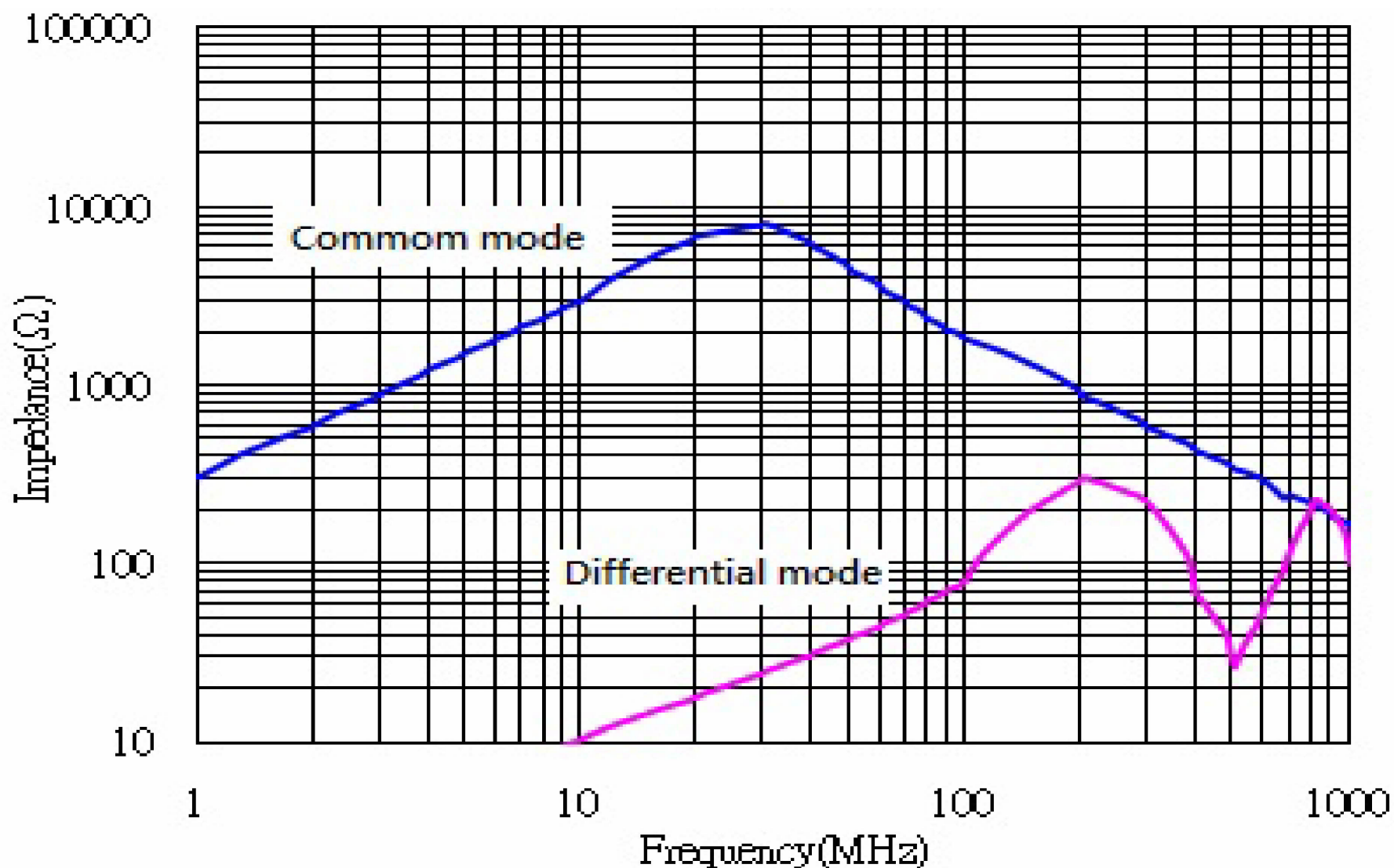

DOC. REV: A/5

PROPRIETARY

Document is the property of XFMRS Group & is not allowed to be duplicated without authorization.

XFMRS® www.XFMRS.com		Title: Common Mode Choke	
UNLESS OTHERWISE SPECIFIED TOLERANCES: .xx ±0.25 Dimensions in MM		P/N: XFWCMC4532A-510 REV. A	
		DWN.	Yuan
		CHK.	YK Liao
SHEET 2 OF 2		APP.	TCH
			Jul-16-20

TAPE AND REEL SPECIFICATION:

NOTES:

- 1) PROCESS IN ACCORDANCE WITH EIA-481-2 STANDARDS
 - * TAPE LEADER DIMENSION 15.30" MIN.
 - * TAPE TRAILER DIMENSION 6.30" MIN.
- 2) PARTS SHOULD BE PACKAGED IN ACCORDANCE WITH ESD GUIDELINES IN EIA-541.
- 3) REEL LABEL: 'A' * PART NUMBER
 - * QUANTITY
 - * DATE CODE
- 4) 500PCS PER 7" REEL

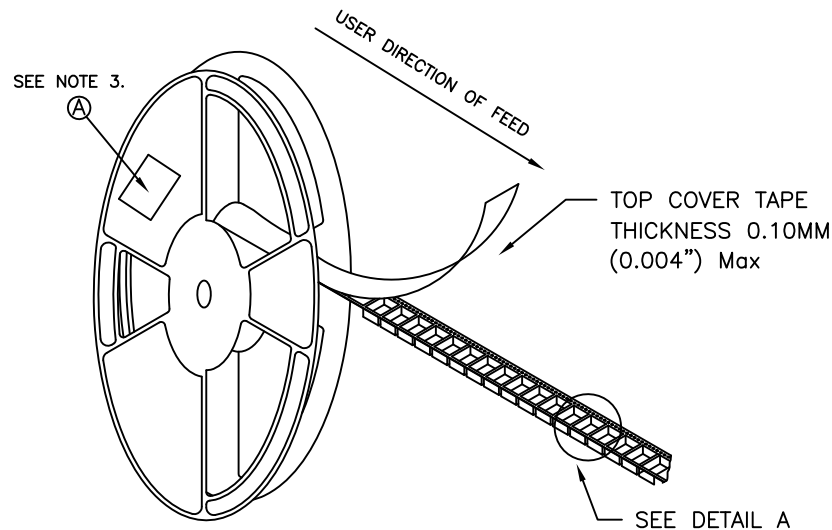

REEL AND TAPE ORIENTATION

7" REEL DIAMETER

DETAIL A

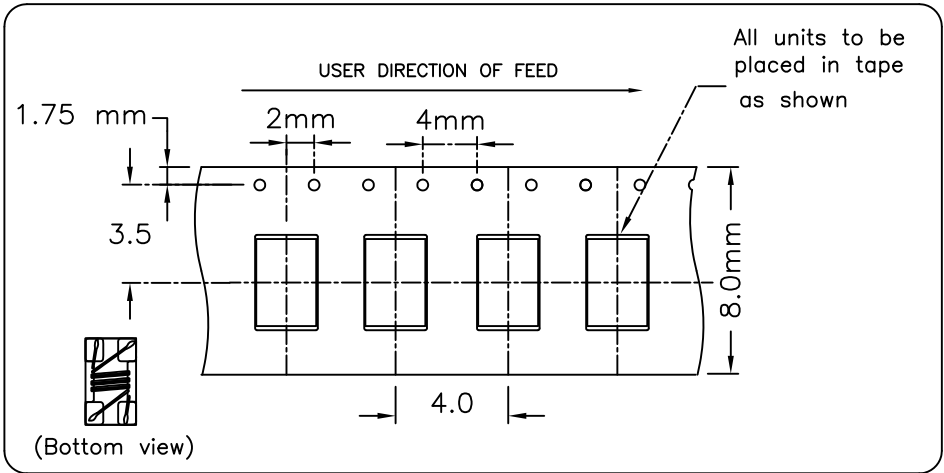

DOC. REV. A/1

XFMRS Inc		Title: T&R SPEC	
UNLESS OTHERWISE SPECIFIED TOLERANCES: .xxs ±xxxxx Dimensions in mm		P/N:XFWCMC4532A series	
		DWN.	Kong
		CHK.	YK Liao
SHT 1 OF 1		APP.	GL
			REV. A
			Nov-28-17
			Nov-28-17
			Nov-28-17

PROPRIETARY

Document is the property of XFMRS Group & is not allowed to be duplicated without authorization.

XFMRS

Recommended Infrared Reflow Temperature Profile for Select Parts

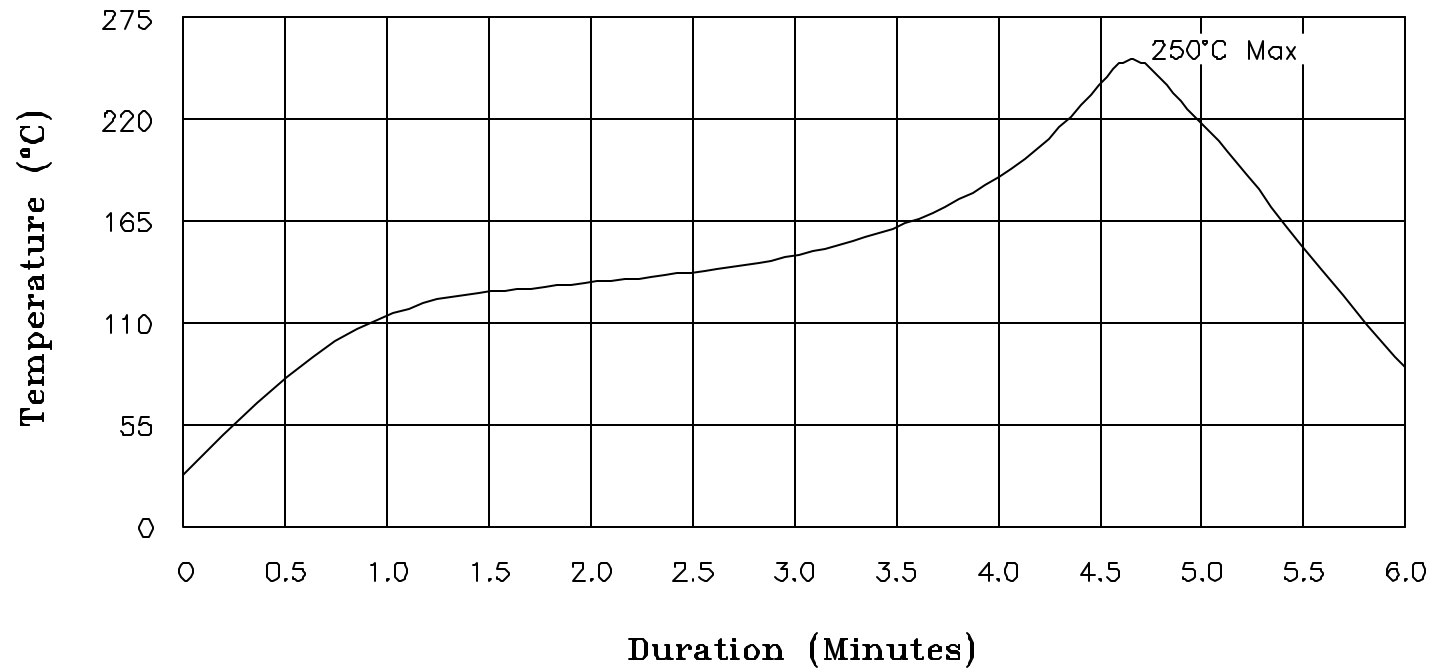

NOTES: Maximum duration at 250°+0/−5° shall be 10–15 seconds.

Maximum duration above 217° shall be 50–120 seconds.

ALL Temperatures refer to topside of the package, measured on the package body surface.

XFMRS Inc www.XFMRS.com UNLESS OTHERWISE SPECIFIED TOLERANCES: N/A	Title: IR REFLOW CHART (250°C)		
	P/N: N/A		REV. A
	DWN.	Juan Mao	Dec-20-06
	CHK.	YK Liao	Dec-20-06
SHEET 1 OF 1	APP.	Joe Huff	Dec-20-06

PROPRIETARY

Document is the property of XFMRS Group & is not allowed to be duplicated without authorization.