

1. Mechanical Dimensions:

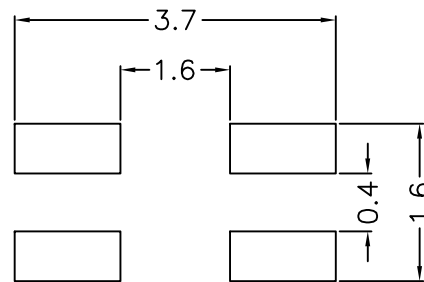

Suggest Pad Layout

2. Schematic:

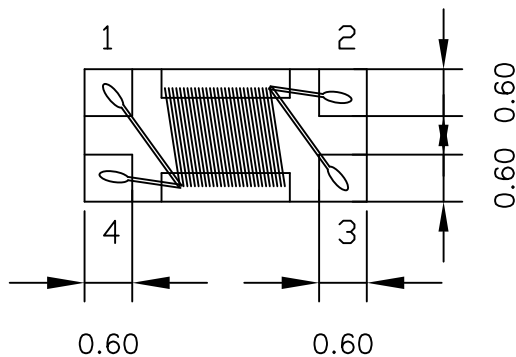
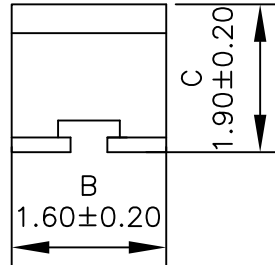
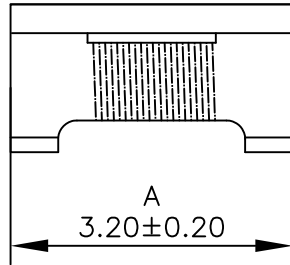
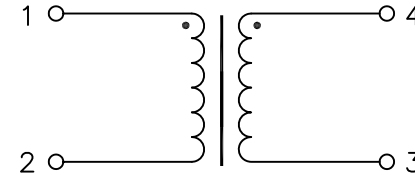

3. Electrical Specifications:

- Common Mode Impedance: 90 Ohms $\pm 25\%$ @100MHz
- Rated Current: 400mA
- Rated Voltage: 50Vdc
- DCR: 0.30 Ohms Max
- Withstand Voltage: 125Vdc
- Insulation Resistance: 10MOhms Min

Notes:

1. Solderability: Leads shall meet MIL-STD-202G, Method 208H for solderability.
2. Flammability: UL94V-0
3. ASTM oxygen index: > 28%
4. Insulation System: Class F 155°C. UL file E151556
5. Operating Temperature Range: All listed parameters are to be within tolerance from -40°C to +85°C
6. Storage Temperature Range: -55°C to +125°C
7. Aqueous wash compatible
8. SMD Lead Coplanarity: $\pm 0.004"$ (0.102mm)
9. Electrical and mechanical specifications 100% tested
10. RoHS Compliant Component

DOC. REV: A/2

XFMRS Inc	Title: Common Mode Choke		
UNLESS OTHERWISE SPECIFIED TOLERANCES: .xx ± 0.20 Dimensions in MM	P/N: XFWCMC321619-900	REV A	
	DWN.	Yuan	Apr-26-16
Scale 2.5:1 SHT 1 OF 1	CHK.	YK Liao	Apr-26-16
	APP.	GL	Apr-26-16

PROPRIETARY

Document is the property of XFMRs Group & is not allowed to be duplicated without authorization.