

## 1. Mechanical Dimensions:

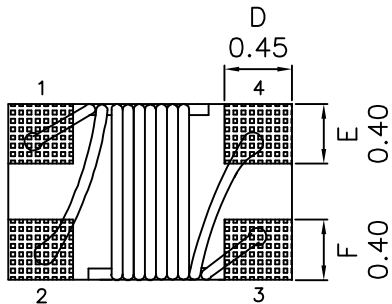

Bottom view

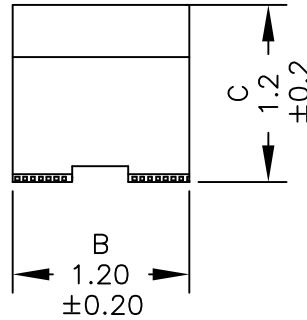
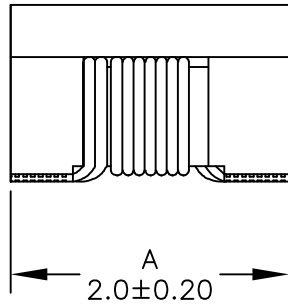
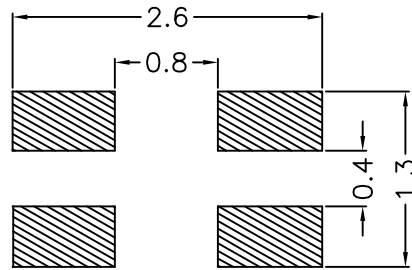

Suggested PCB Layout

## 2. Schematic:

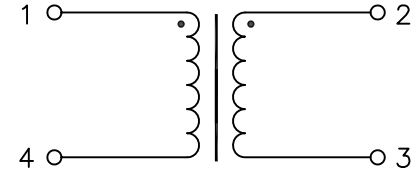

## 3. Electrical Specifications: @25°C

Common Mode Impedance: 90 Ohms  $\pm 20\%$  @100MHz

Inductance: 47 nH Min @100MHz

DCR: 0.170 Ohms Max each

Rated Current: 500mA dc Max

Rated Voltage: 50Vdc

Insulation Resistance: 10 MOhms Min.(1 minute)

Withstand Voltage: 125Vdc

### Notes:

1. Solderability: Leads shall meet MIL-STD-202G, Method 208H for solderability.
2. Flammability: UL94V-0
3. ASTM oxygen index: > 28%
4. Insulation System: Class F 155°C. UL file E151556
5. Operating Temperature Range: All listed parameters are to be within tolerance from -40°C to +125°C
6. Storage Temperature Range: -55°C to +125°C
7. Aqueous wash compatible
8. SMD Lead Coplanarity:  $\pm 0.004''$  (0.102mm)
9. Electrical and mechanical specifications 100% tested
10. RoHS Compliant Component
11. Recommended IR Reflow peak temp of 250°C Max.
12. Outsourced item processed & controlled under XFMR QA system

<b>XFMR Inc</b> www.XFMR.com		Title: Common Mode Choke	
UNLESS OTHERWISE SPECIFIED TOLERANCES: .xx $\pm 0.20$ Dimensions in MM	P/N: XFWCMC201213-900	REV. A	
	DWN.	Yuan	May-06-16
	CHK.	YK Liao	May-06-16
SHEET 1 OF 2	APP.	GL	May-06-16

DOC. REV: A/7

**PROPRIETARY**

Document is the property of XFMR Group & is not allowed to be duplicated without authorization.

# F4P2012-900

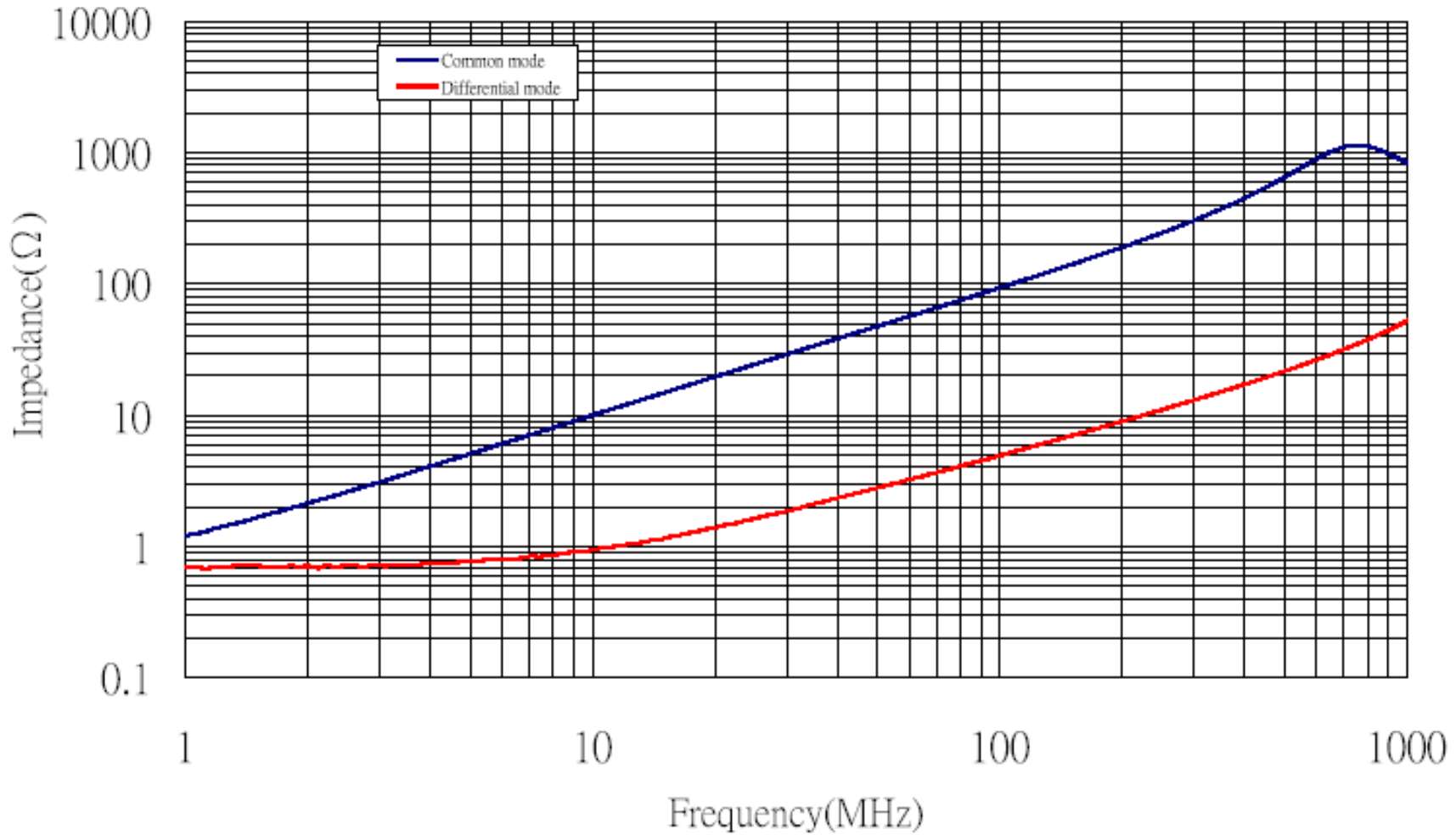

DOC. REV: A/7

<b>XFMRs Inc</b> www.XFMRS.com	Title: Common Mode Choke		
	UNLESS OTHERWISE SPECIFIED TOLERANCES: .xx ±0.20 Dimensions in MM	P/N: XFWCMC201213-900	REV. A
SHEET 2 OF 2	DWN.	Yuan	May-06-16
	CHK.	YK Liao	May-06-16
	APP.	GL	May-06-16