

1. Mechanical Dimensions:

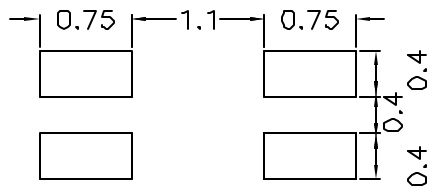

Suggested PCB Layout

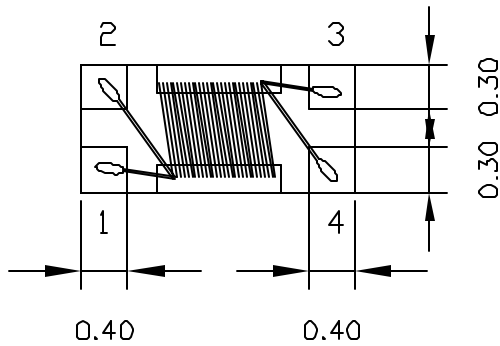
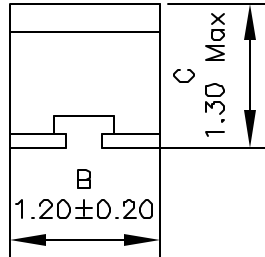
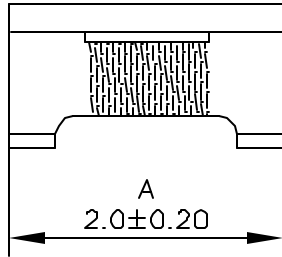
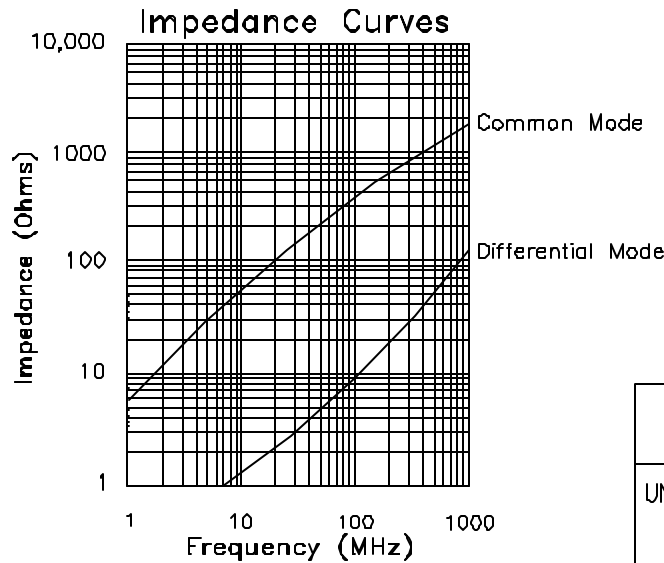

DOC. REV: A/2

2. Schematic:

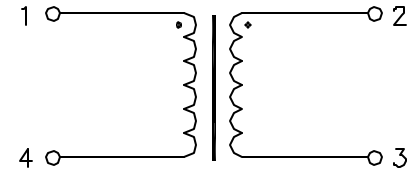

3. Electrical Specifications:

Common Mode Impedance: 360 Ohms Typ @100MHz
 Rated Current: 220mA_{dc}
 Rated Voltage: 50V_{dc}
 DCR: 0.50 Ohms Max
 Withstand Voltage: 125V_{dc}

Notes:

1. Solderability: Leads shall meet MIL-STD-202G, Method 208H for solderability.
2. Flammability: UL94V-0
3. ASTM oxygen index: > 28%
4. Insulation System: Class F 155°C. UL file E151556
5. Operating Temperature Range: All listed parameters are to be within tolerance from -40°C to +85°C
6. Storage Temperature Range: -55°C to +125°C
7. Aqueous wash compatible
8. SMD Lead Coplanarity: ±0.004" (0.102mm)
9. Electrical and mechanical specifications 100% tested
10. RoHS Compliant Component

XFMRs Inc www.XFMRs.com		Title: Common Mode Choke	
UNLESS OTHERWISE SPECIFIED TOLERANCES: .xx ±0.20 Dimensions in MM		P/N: XFWMCMC201213-361	REV A
		DWN.	李小锋 Dec-21-07
Scale 2.5:1 SHT 1 OF 1		CHK.	康玉坤 Dec-21-07
		APP.	BW Dec-21-07

PROPRIETARY

Document is the property of XFMRs Group & is not allowed to be duplicated without authorization.