

## 1. Mechanical Dimensions:

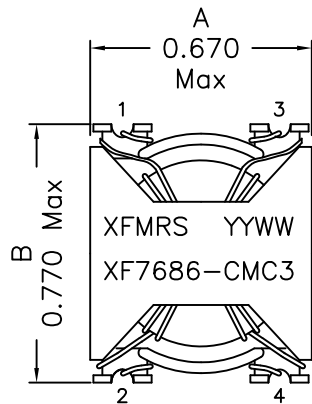

Top view

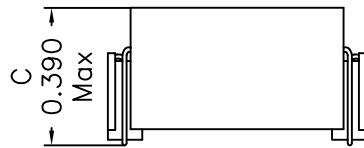
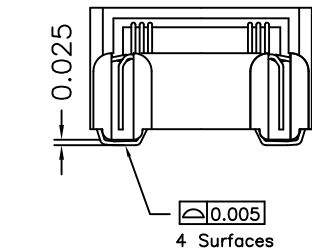
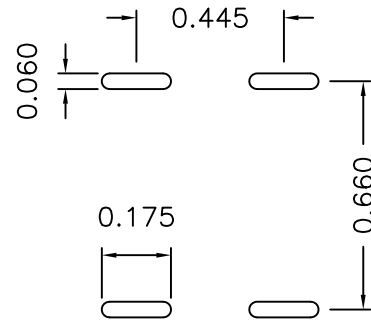

(SUGGESTED MOUNTING PAD)

## 2. Schematic:

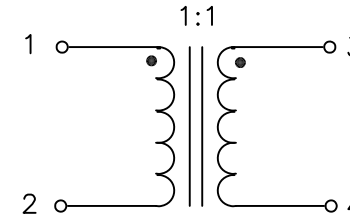

## 3. Electrical Specifications: @25°C

Turns Ratio: 1:1

OCL: 0.768mH  $\pm$ 25% @10KHz, 1.0V each

Q: 2.5 Min @10KHz, 1.0V each

DCR: 0.040 OHMS Max each

Rated Current (For 55c Rise): 4.7 A

Hipot: 1000Vrms (wdg. to wdg.)

SRF: 1.0MHz Min

### Notes:

1. Solderability: Leads shall meet MIL-STD-202G, Method 208H for solderability.
2. Flammability: UL94V-0
3. ASTM oxygen index: > 28%
4. Insulation System: Class F 155°C. UL file E151556
5. All listed parameters are to be within tolerance from -40C to +85C unless otherwise noted.
6. Storage Temperature Range: -55°C to +125°C
7. Aqueous wash compatible
8. SMD Lead Coplanarity:  $\pm$ 0.004"(0.102mm)
9. Electrical and mechanical specifications 100% tested
10. RoHS Compliant Component
11. Recommended IR Reflow peak temp of 235°C Max.

DOC. REV: A/9

<b>XFMR5 Inc</b> <a href="http://www.XFMR5.com">www.XFMR5.com</a>	Title: Common Mode Choke		
	UNLESS OTHERWISE SPECIFIED	P/N: XF7686-CMC3	REV. A
TOLERANCES:	DWN.	Yuan	Apr-29-15
.xxx $\pm$ 0.010	CHK.	YK Liao	Apr-29-15
Dimensions in Inch	APP.	BW	Apr-29-15
SHEET 1 OF 2			

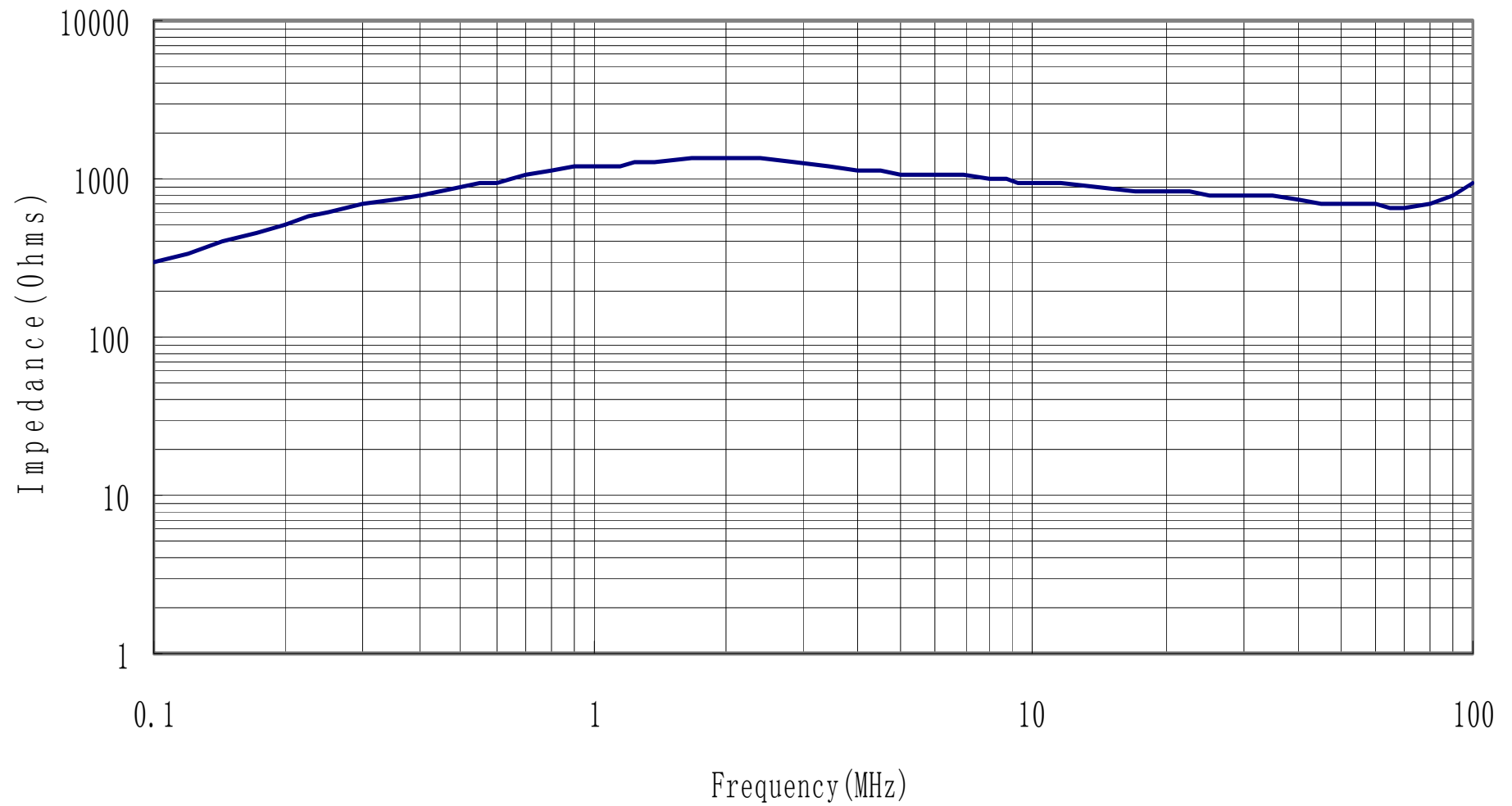

<b>XFMRs Inc</b> www.XFMRS.com  UNLESS OTHERWISE SPECIFIED TOLERANCES: .xxx ±0.010 Dimensions in Inch  SHEET 2 OF 2	Title: Common Mode Choke		
	P/N: XF7686-CMC3		REV. A
	DWN.	Yuan	Apr-29-15
	CHK.	YK Liao	Apr-29-15
	APP.	BW	Apr-29-15

DOC. REV: A/9