

1. Mechanical Dimensions:

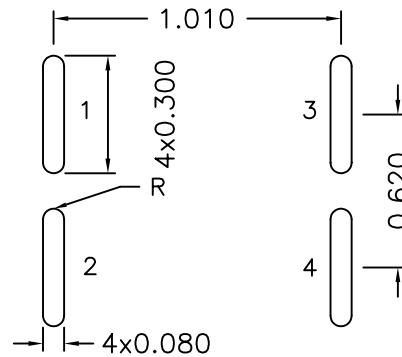

(SUGGESTED PAD LAYOUT)

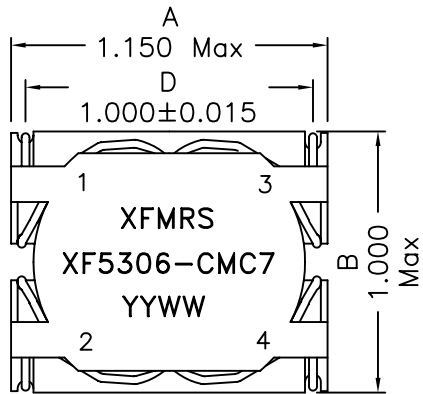
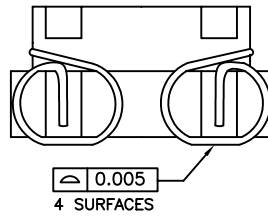
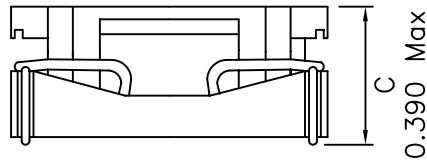
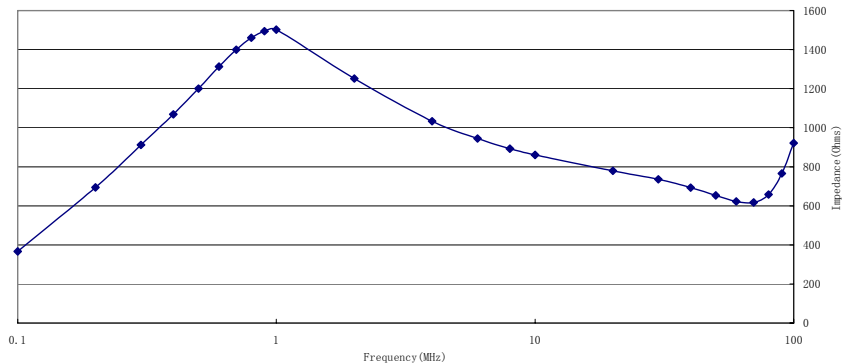

2. Schematic:

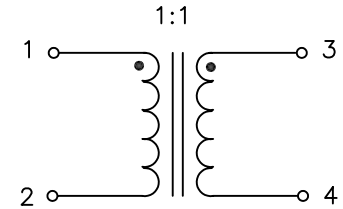

3. Electrical Specifications:

- OCL: 0.530mH ± 35% @ 100KHz 0.1V, Each Wdg
- Q: 10 Min @ 10KHz 0.1V, Each Wdg
- Rated Current: 7.2A
- DCR: 0.015 Ohms Max, Each Wdg
- TURNS RATIO: Pins (1-2):(3-4) = 1:1 ± 1%
- HIPOT: 1000Vac, Wdg to Wdg, 1 Sec

Notes:

1. Solderability: Leads shall meet MIL-STD-202G, Method 208H for solderability.
2. Flammability: UL94V-0
3. ASTM oxygen index: > 28%
4. Insulation System: Class F 155°C. UL file E151556
5. Operating Temperature Range: All listed parameters are to be within tolerance from -40°C to +85°C
6. Storage Temperature Range: -55°C to +125°C
7. Aqueous wash compatible
8. SMD Lead Coplanarity: ±0.004" (0.102mm)
9. Electrical and mechanical specifications 100% tested
10. RoHS Compliant Component

DOC REV: A/9

XFMR5 Inc. www.XFMR5.com	Title: SELF-LEADED SMT COMMON MODE CHOKE		
	UNLESS OTHERWISE SPECIFIED TOLERANCES: .xxx ±0.010 Dimensions in INCH	P/N: XF5306-CMC7	REV. A
SHEET 1 OF 1	APP.	YK Liao	Jul-22-10
	BW	Jul-22-10	