

1. Mechanical Dimensions:

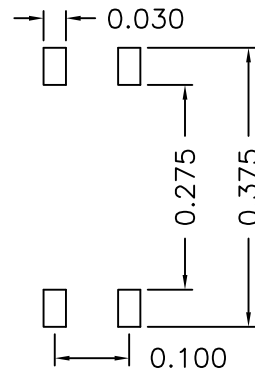

SUGGESTED FOOTPRINT

2. Schematic:

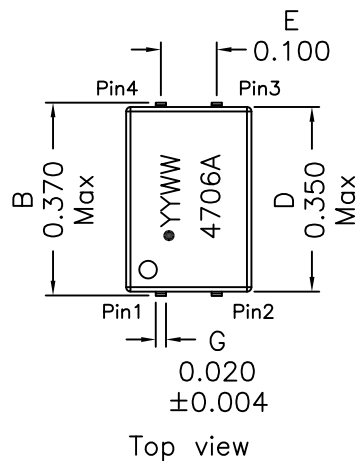
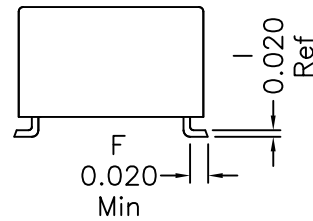
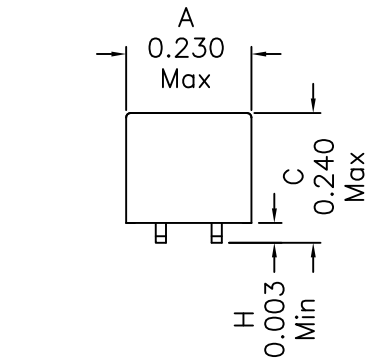
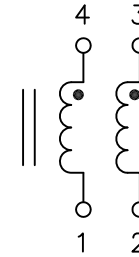

3. Electrical Specifications: @25°C

Rated Voltage: 80Vdc

Rated Current: 0.7A_{dc}

DCR: 0.20 Ohms Typ, 0.25 Ohms Max each wdg.

OCL: 470uH+50%–30% @100KHz, 0.1V Each Wdg.

LL: Pin4–1 0.20uH Typ @100KHz, 0.1V Tie 3–2

Isolation: 750Vdc 2 Sec

Q: P4–1 8 Min @10KHz, 50mV

Notes:

1. Solderability: Leads shall meet MIL-STD-202G, Method 208H for solderability.
2. Flammability: UL94V-0
3. ASTM oxygen index: > 28%
4. Insulation System: Class F 155°C. UL file E151556
5. All listed parameters are to be within tolerance from -40°C to +85°C unless otherwise noted.
6. Storage Temperature Range: -55°C to +125°C
7. Aqueous wash compatible
8. SMD Lead Coplanarity: ±0.004"(0.102mm)
9. Electrical and mechanical specifications 100% tested
10. RoHS Compliant Component
11. Recommended IR Reflow peak temp of 250°C Max.

DOC. REV: A/8

XFMRs Inc www.XFMRS.com	Title: Common Mode Choke		
	UNLESS OTHERWISE SPECIFIED TOLERANCES: .xxx ±0.010 Dimensions in Inch	P/N: XF4706A-00SM	REV. A
SHEET 1 OF 2	DWN.	Yuan	Dec-17-14
	CHK.	YK Liao	Dec-17-14
	APP.	DDC	Dec-17-14

PROPRIETARY

Document is the property of XFMRs Group & is not allowed to be duplicated without authorization.

XF4706A-00SM Impedance graph

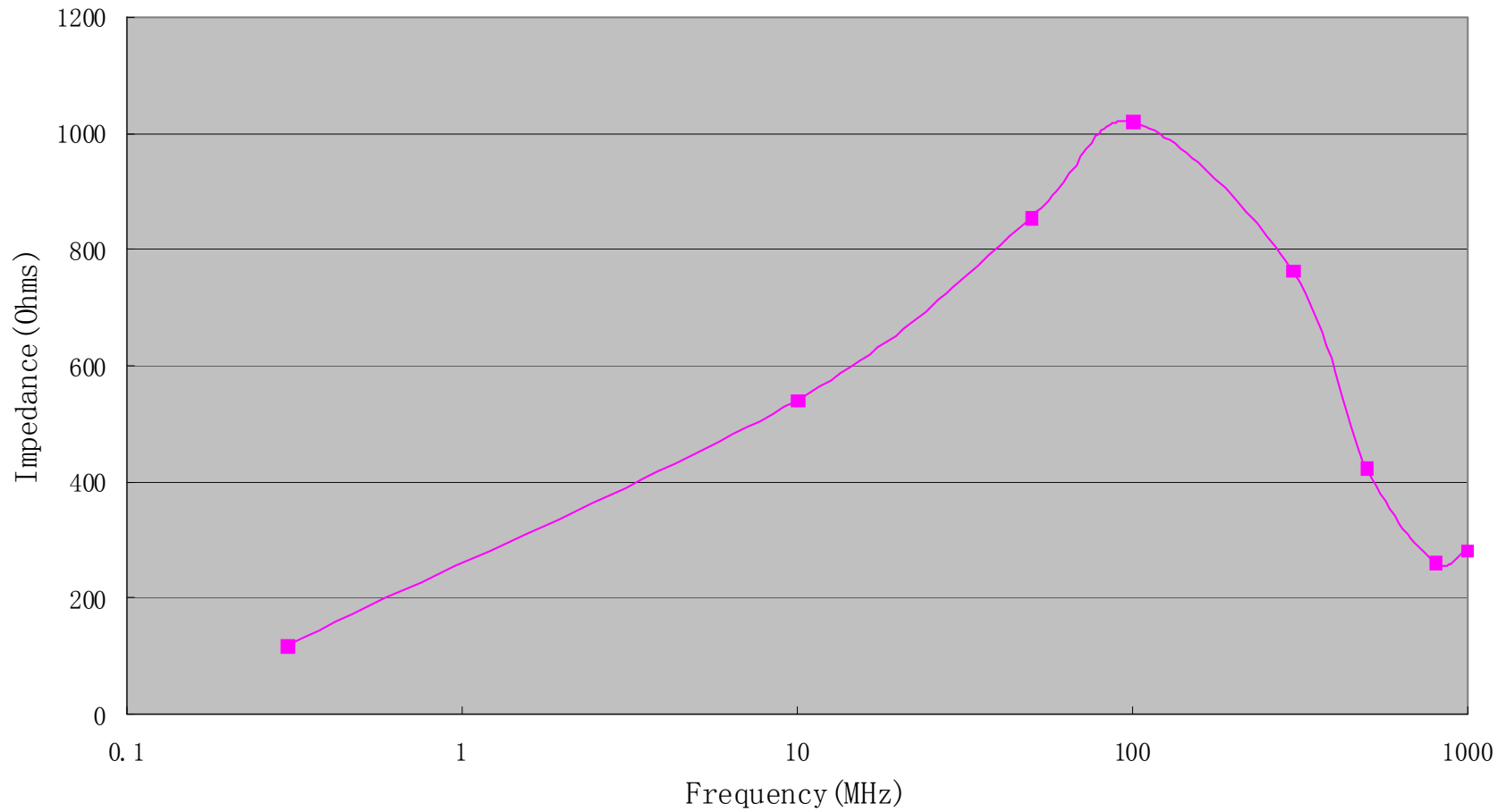

DOC. REV: A/8

XFMRs Inc www.XFMRS.com	Title: Common Mode Choke		
	UNLESS OTHERWISE SPECIFIED TOLERANCES: .xxx ±0.010 Dimensions in Inch		P/N: XF4706A-00SM
SHEET 2 OF 2	DWN.	Yuan	Dec-17-14
	CHK.	YK Liao	Dec-17-14
	APP.	DDC	Dec-17-14