

## 1. Mechanical Dimensions:

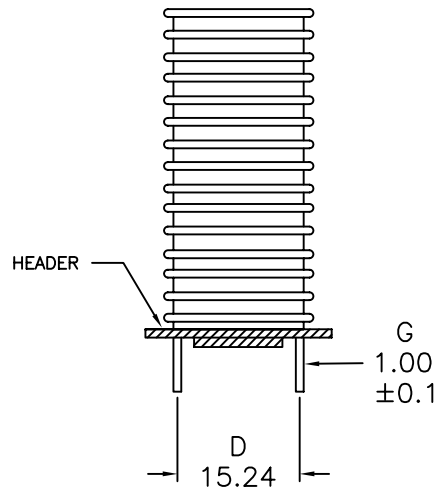

## 2. Schematic:

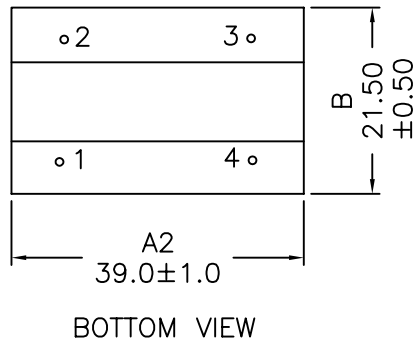
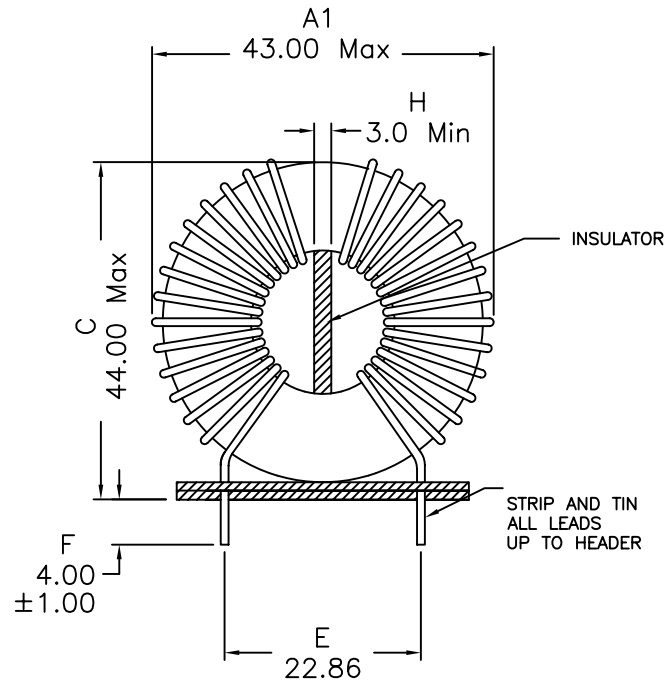
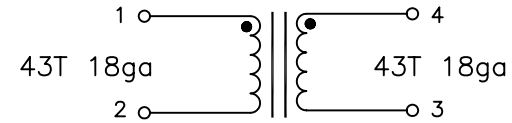

Core: Metglas FT-3KMF3320E

## 3. Electrical Specifications:

- OCL: 145mH±30% @1.0KHz 0.1V, Each Wdg
- LL: Pins 1-2 150uH Max @1.0KHz 0.1V (short 4-3)
- Q: Pins 1-2 10 Min @1.0KHz, 0.1V
- Rated Voltage: 250VAC
- DCR: 155mOhms Max, Each Wdg
- Current Rating: 8.5Arms
- Hipot: 1500Vac, Wdg to Wdg

### Notes:

1. Solderability: Leads shall meet MIL-STD-202G, Method 208H for solderability.
2. Flammability: UL94V-0
3. ASTM oxygen index: > 28%
4. Insulation System: Class F 155°C. UL file E151556
5. All listed parameters are to be within tolerance from -40°C to +125°C unless otherwise noted.
6. Storage Temperature Range: -55°C to +125°C
7. Aqueous wash compatible
8. Electrical and mechanical specifications 100% tested
9. RoHS Compliant Component

<b>XFMRs Inc</b> www.XFMRs.com	Title: COMMON MODE CHOKE		
	UNLESS OTHERWISE SPECIFIED TOLERANCES:	P/N: XF1453-VMCMC	REV. A
.xx ±0.25	DWN.	Mei Chen	Oct-13-10
Dimensions in MM	CHK.	YK Liao	Oct-13-10
SHEET 1 OF 1	APP.	BW	Oct-13-10

DOC REV: A/2

**PROPRIETARY**

Document is the property of XFMRs Group & is not allowed to be duplicated without authorization.