

1. Mechanical Dimensions:

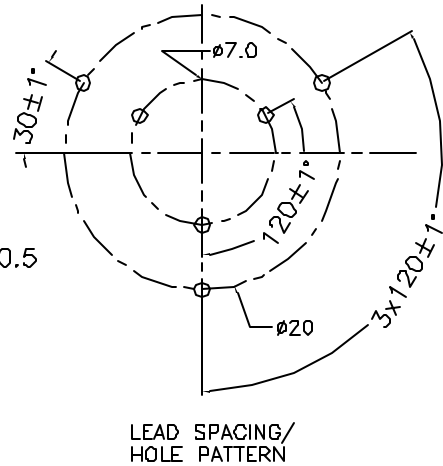

2. Schematic:

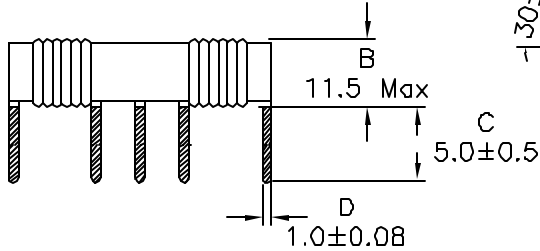
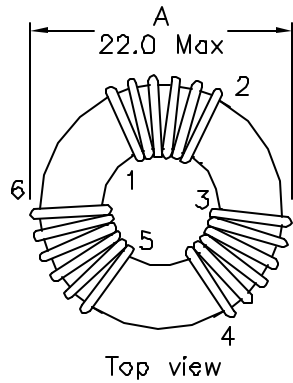
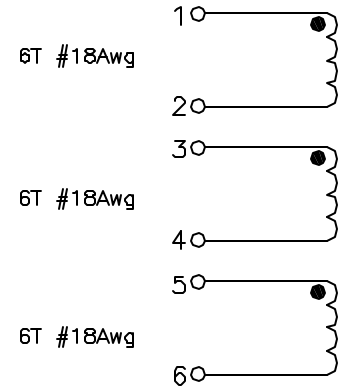

Core: Acme A10 T16x9.6x6.1C

3. Electrical Specifications: @25°C

OCL: 150uH Min @10KHz 0.1V, Each wdg (0°C to 85°C)
60uH Min @10KHz 0.1V, Each wdg (-40°C to 0°C)

Q: Pins 1-2 10 Min @10KHz 0.1V

DCR: 6.0 mOhms Max, Each Wdg

Rated Current: 15Adc (Balanced)

Turns Ratio: (1-2):(3-4):(5-6)=1:1:1±2%

Hipot: 500Vac, Wdg to Wdg

Notes:

1. Solderability: Leads shall meet MIL-STD-202G, Method 208H for solderability.
2. Flammability: UL94V-0
3. ASTM oxygen Index: > 28%
4. Insulation System: Class F 155°C, UL file E151556
5. All listed parameters are to be within tolerance from -40°C to +85°C unless otherwise noted
6. Storage Temperature Range: -55°C to +125°C
7. Aqueous wash compatible
8. Electrical and mechanical specifications 100% tested
9. RoHS Compliant Component

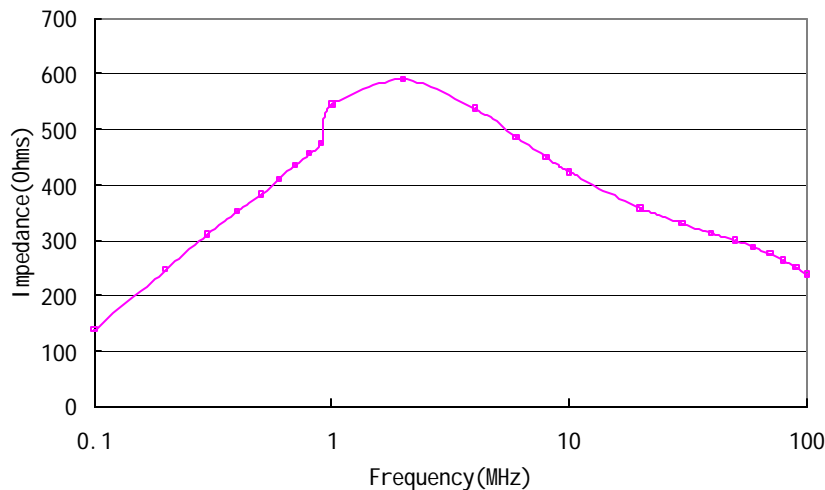

Doc. Rev. A/2

XFMRs Inc. www.XFMRs.com	Title: 3 Line CMC		
	UNLESS OTHERWISE SPECIFIED TOLERANCES: .xx ±0.25	P/N: XF1006-3HDCMC	REV. A
Dimensions in MM	DWN.	Feng	Nov-10-10
SHEET 1 OF 1	CHK.	YK Liao	Nov-10-10
	APP.	Joe Huff	Nov-10-10