

1. Mechanical Dimensions:

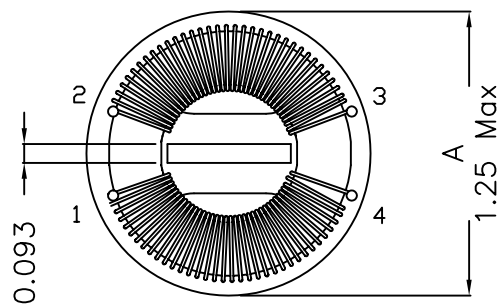

(TOP VIEW)

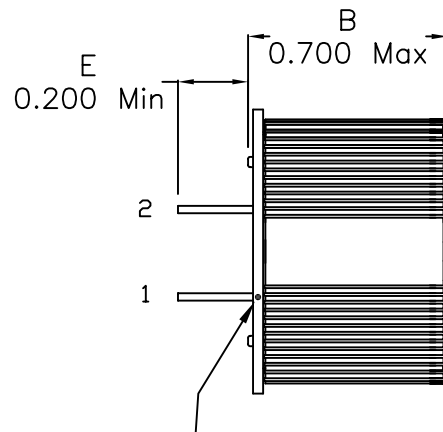

White Dot on side of base denotes Pin #1.

2. Schematic:

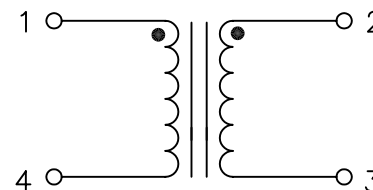

3. Electrical Specifications: @25°C

OCL: 6.9mH±30% @1KHz 0.1V, Each Wdg

DCR: 0.030 Ohms Max, Each Wdg

HIPOT: 2000Vac, Wdg to Wdg

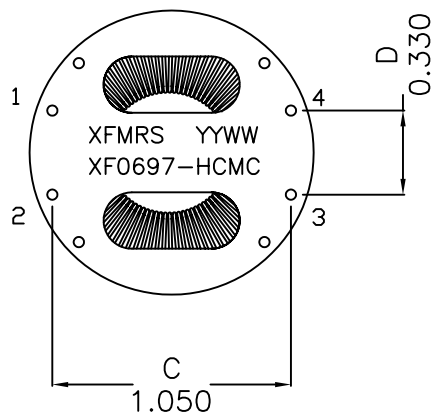

(BOTTOM VIEW)

Notes:

1. Solderability: Leads shall meet MIL-STD-202, Method 208D for solderability.
2. Flammability: UL94V-0
3. ASTM oxygen index: > 28%
4. Insulation System: Class F 155°C. UL file E151556
5. Operating Temperature Range: All listed parameters are to be within tolerance from -40°C to +85°C
6. Storage Temperature Range: -55°C to +125°C
7. Aqueous wash compatible
8. SMD Lead Coplanarity: ±0.004"(0.102mm)
9. Moisture Sensitivity: Level 3
10. Electrical and mechanical specifications 100% tested
11. RoHS Compliant Component

DOC REV: A/2

XFMRS Inc www.XFMRS.com	Title: Common Mode Choke		
	UNLESS OTHERWISE SPECIFIED TOLERANCES: .xxx ±0.020 Dimensions in INCH	P/N: XF0697-HCMC	REV. A
SCALE 2.5:1 SHT 1 OF 1	CHK. YK Liao Mar-01-05	APP. Isaiah M Mar-01-05	Mar-01-05

PROPRIETARY

Document is the property of XFMRS Group & is not allowed to be duplicated without authorization.