

1. Mechanical Dimensions:

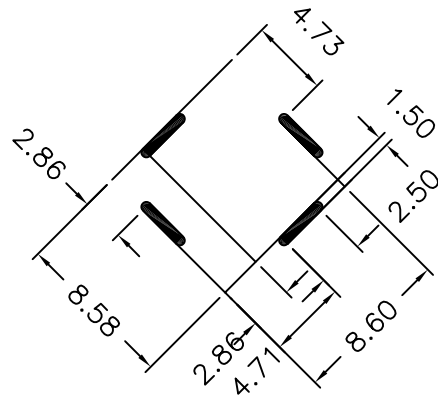

RECOMMENDED PCB ALYOUT

2. Schematic:

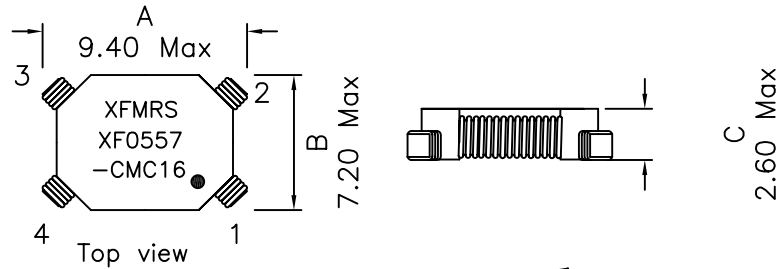
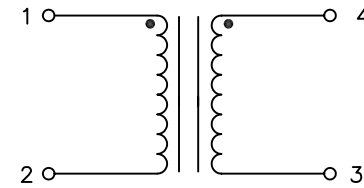

3. Electrical Specifications:

- OCL: 5.5uH Nom @100KHz 0.1V Each Wdg
- LL: 0.05uH Typ @100KHz 0.1V
- DCR: 0.0027 Ohms Typ Each Wdg
- CW/W: Pins 1-4 2.0pF Typ @100KHz 0.1V
- I_{rms} Amperes: 7.0A Max
- Turns Ratio: Pins (1-2):(4-3)=1:1
- HIPOT: 300Vdc for 1Sec Winding to Winding

Notes:

1. Solderability: Leads shall meet MIL-STD-202G, Method 208H for solderability.
2. Flammability: UL94V-0
3. ASTM oxygen index: > 28%
4. Insulation System: Class F 155°C. UL file E151556
5. Operating Temperature Range: All listed parameters are to be within tolerance from -40°C to +85°C
6. Storage Temperature Range: -55°C to +125°C
7. Aqueous wash compatible
8. SMD Lead Coplanarity: ±0.004"(0.102mm)
9. Electrical and mechanical specifications 100% tested
10. RoHS Compliant Component

DOC. REV. A/1

XFMR5 Inc www.XFMR5.com	Title: TRANSFORMER		
	UNLESS OTHERWISE SPECIFIED TOLERANCES:	P/N: XF0557-CMC16	REV. A
.xx ±0.25 Dimensions in MM	DWN.	Juan Mao	Dec-30-08
	CHK.	YK liao	Dec-30-08
SHEET 1 OF 1	APP.	BW	Dec-30-08