

1. Mechanical Dimensions:

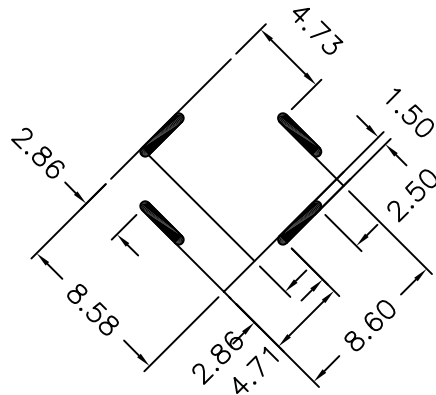

RECOMMENDED PCB LAYOUT

2. Schematic:

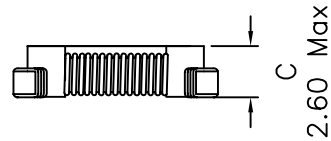
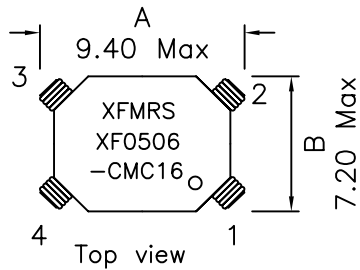
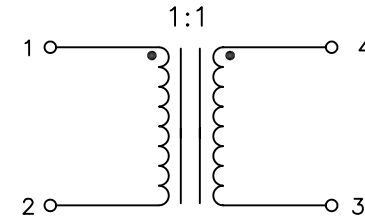

3. Electrical Specifications:

OCL: 50uH Typ @100KHz 0.1V Each Wdg (0°C to +85°C)
 tbd uH Min @100KHz 0.1V Each Wdg (-40°C to 0°C)

Q: tbd Min @100KHz 0.1V Each Wdg

LL: 0.45uH Typ @100KHz 0.1V

DCR: 0.019 Ohms Max Each Wdg

Cw/w: Pins 1-4 2.6pF Typ @100KHz 0.1V

Irms Amperes: 2.60 Arms Max (apx 40°C temp rise)

Turns Ratio: (1-2):(4-3)=1:1

Hipot: 300Vdc for 1Sec Winding to Winding

Notes:

- Solderability: Leads shall meet MIL-STD-202G, Method 208H for solderability.
- Flammability: UL94V-0
- ASTM oxygen index: > 28%
- Insulation System: Class F 155°C. UL file E151556
- All listed parameters are to be within tolerance from -40°C to +85°C unless otherwise noted.
- Storage Temperature Range: -55°C to +125°C
- Aqueous wash compatible
- SMD Lead Coplanarity: ±0.004"(0.102mm)
- Electrical and mechanical specifications 100% tested
- RoHS Compliant Component

DOC. REV. A/1

XFMR5 Inc www.XFMR5.com	Title: smd CMC		
	UNLESS OTHERWISE SPECIFIED	P/N: XF0506-CMC16	REV. A
TOLERANCES: .xx ±0.25 Dimensions in MM	DWN.	Xiany	Dec-21-09
	CHK.	YK liao	Dec-21-09
SHEET 1 OF 1	APP.	BW	Dec-21-09