

### 1. Mechanical Dimensions:

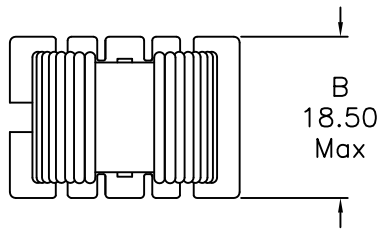

TOP VIEW

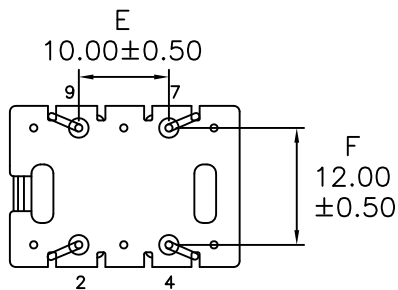
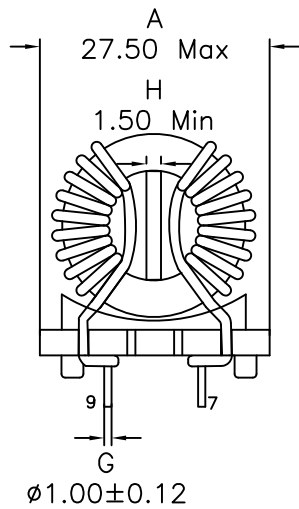

BOTTOM VIEW

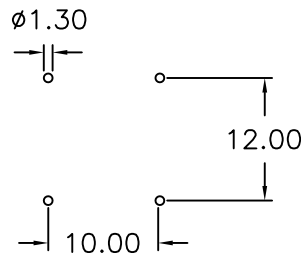
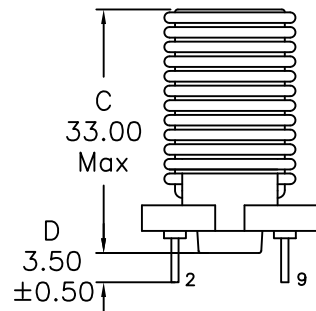

PCB layout

### 2. Schematic:

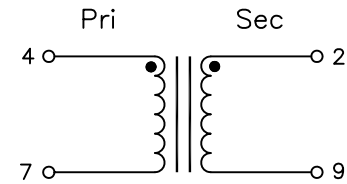

### 3. Electrical Specifications: @25°C

OCL: 2.2mH $\pm 30\%$  @10KHz 0.1mA Each Wdg

0.4mH Min @10KHz 0.1mA Each Wdg at -40C to 0C

2.2mH Min @10KHz 0.1mA Each Wdg at 70C to 85C

Q: 10 Min @10KHz 0.1mA Each Wdg

LL: Pins 4-7 15 uH Max @100KHz 0.1V, Short Sec

Rated Current: 6.0A Max @70°C

Rated Voltage: 250VAC Max 50Hz

DCR: 20 mOhms Max Each Wdg

Turns Ratio: (4-7):(2-9) = 1:1 $\pm 2\%$

Hipot: 1500Vac, Pri to Sec 50Hz 5mA 2Sec

SRF: Pins 4-7 700KHz Min

Notes:

1. Solderability: Leads shall meet MIL-STD-202G, Method 208H for solderability.
2. Flammability: UL94V-0
3. ASTM oxygen index: > 28%
4. Insulation System: Class F 155°C. UL file E151556
5. All listed parameters are to be within tolerance from -40°C to +125°C noted otherwise noted
6. Storage Temperature Range: -20°C to +60°C
7. Aqueous wash compatible
8. Electrical and mechanical specifications 100% tested
9. RoHS Compliant Component

<b>XFMRs Inc</b> www.XFMRs.com	Title: COMMON MODE CHOKE		
	UNLESS OTHERWISE SPECIFIED TOLERANCES: .xx $\pm 0.25$	P/N: XF0224L-VMCMC9	REV. A
Dimensions in MM	DWN.	Xiang	May-20-16
	CHK.	YK Liao	May-20-16
SHEET 1 OF 2	APP.	BSJ	May-20-16

DOC. REV: A/2

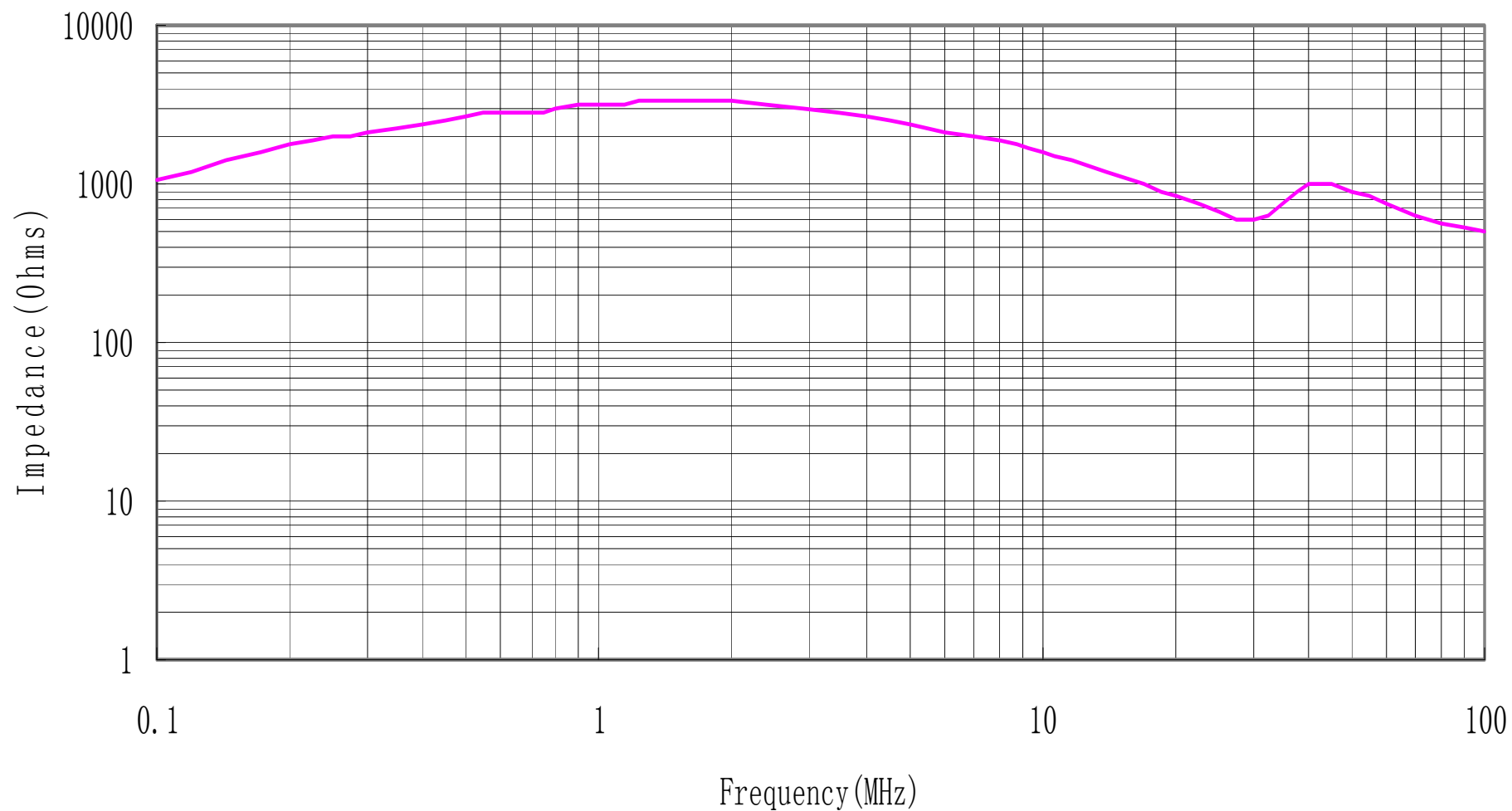

DOC. REV: A/2

<b>XFMRs Inc</b> www.XFMRS.com	Title: COMMON MODE CHOKE		
	P/N: XF0224L-VMCMC9		REV. A
UNLESS OTHERWISE SPECIFIED TOLERANCES: .xx ±0.25 Dimensions in MM	DWN.	Xiang	May-20-16
	CHK.	YK Liao	May-20-16
SHEET 2 OF 2	APP.	BSJ	May-20-16

**PROPRIETARY** Document is the property of XFMRs Group & is not allowed to be duplicated without authorization.