

1. Dimensions:

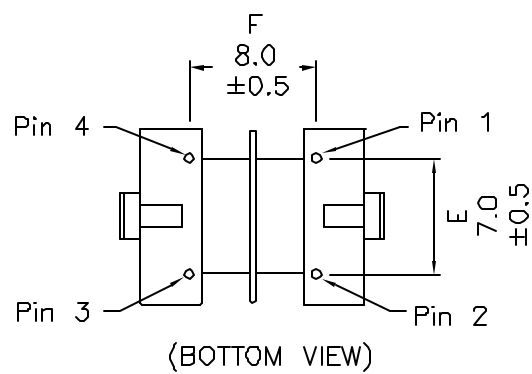

2. Schematic:

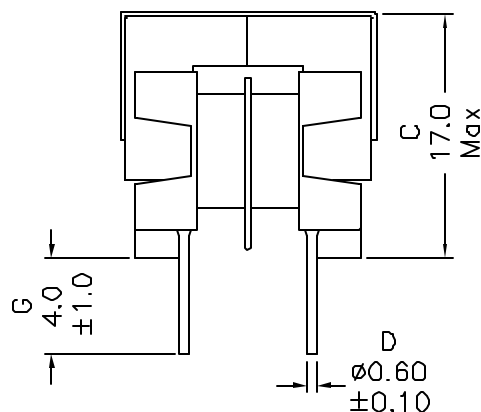
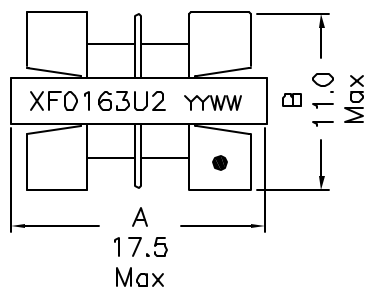
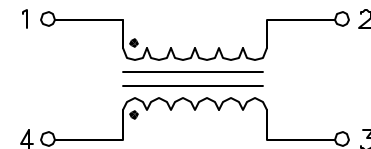

3. Electrical Specifications:

OCL: 16mH Min @10KHz 0.1V @ 25°C

15mH Min @10KHz 0.1V @ 0°C

Q: Pins1-2 20 Min @10KHz 0.1V

LL: Pins1-4 100uH Min #100KHz 0.1V Short Pins2+3

DCR: 2.45 Ohms±15% (each wdg)

Rated Current: 400mArms Max

Turns Ratio: (1-2):(4-3) = 1:1±1%

Rated Voltage: 250VAC Max

Hipot: 3000Vrms Wdg-Wdg, Wdgs-Core

Notes:

- Solderability: Leads shall meet MIL-STD-202G, Method 208H for solderability.
- Flammability: UL94V-0
- ASTM oxygen index: > 28%
- Insulation System: Class F 155°C, UL file E15155B
- Operating Temperature Range: All listed parameters are to be within tolerance from 0°C to +105°C
- Storage Temperature Range: -55°C to +125°C
- Aqueous wash compatible
- Electrical and mechanical specifications 100% tested
- RoHS Compliant Component

DOC, REV: A/2

PROPRIETARY Document is the property of XFMRs Group & is not allowed to be duplicated without authorization.

XFMRs Inc www.XFMRs.com	Title: COMMON MODE CHOKE		
	UNLESS OTHERWISE SPECIFIED TOLERANCES: .xx ±0.30 Dimensions in MM	P/N: XF0163-00U2	REV. A
SHEET 1 OF 1	DWN.	Xianyì	Oct-03-08
	CHK.	YK Liao	Oct-03-08
	APP.	Joe Huff	Oct-03-08