

### 1. Mechanical Dimensions:

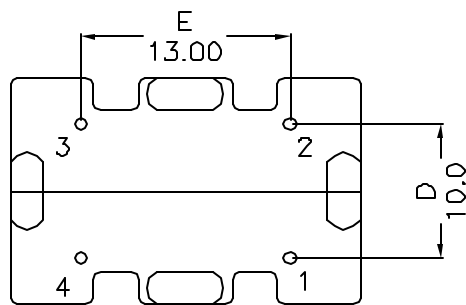

(BOTTOM VIEW)

Marking: (on TOP)

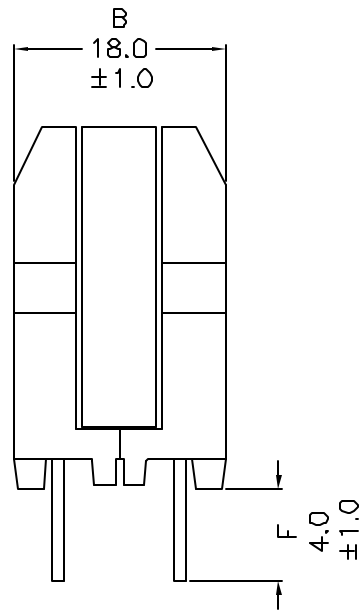
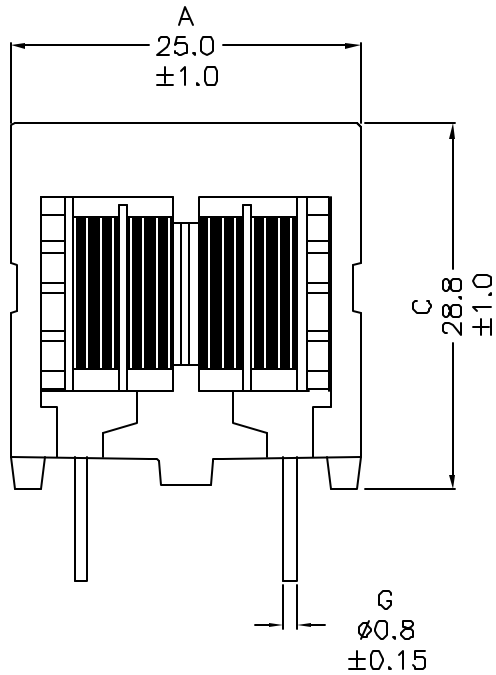
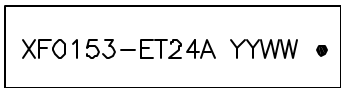

### 2. Schematic:

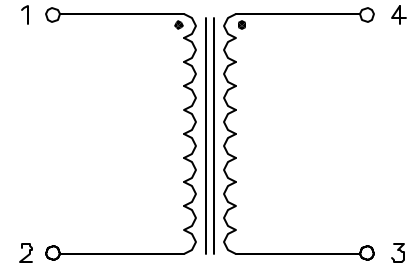

### 3. Electrical Specifications: @25°C

OCL: 15mH Min @10KHz 0.25V, Each Wdg

DCR: 0.550 Ohms Max, Each Wdg

Rated Current: 1Aac Max

HIPOT: 1250VDC 1 second, Wdg to Wdg

Notes:

1. Solderability: Leads shall meet MIL-STD-202G, Method 208H for solderability.
2. Flammability: UL94V-0
3. ASTM oxygen index: > 28%
4. Insulation System: Class F 155°C, UL file E151556
5. Operating Temperature Range: All listed parameters are to be within tolerance from -20°C to +105°C
6. Storage Temperature Range: -55°C to +125°C
7. Aqueous wash compatible
8. Electrical and mechanical specifications 100% tested
9. RoHS Compliant Component

DOC REV: A/2

**PROPRIETARY**

Document is the property of XFMRs Group & is not allowed to be duplicated without authorization.

<b>XFMRs Inc</b> www.XFMRs.com	Title: <b>COMMON MODE CHOKE</b>		
	P/N: XF0153-ET24A	REV. A	
UNLESS OTHERWISE SPECIFIED TOLERANCES: .xx ±0.50 Dimensions in mm	DWN.	Juan Mao	Oct-18-07
	CHK.	YK Liao	Oct-18-07
Scale 2:1 SHT 1 OF 1	APP.	MS	Oct-18-07