

### 1. Mechanical Dimensions:

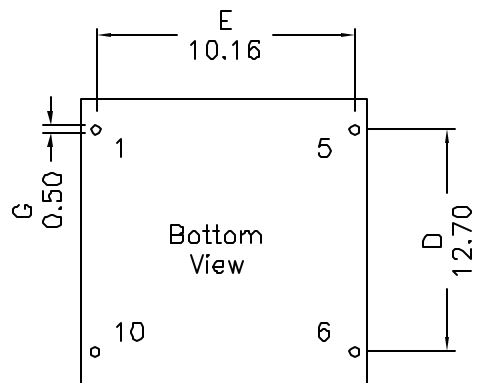

### 2. Schematic:

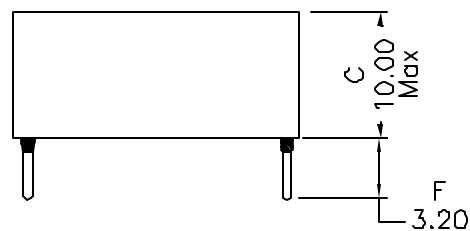
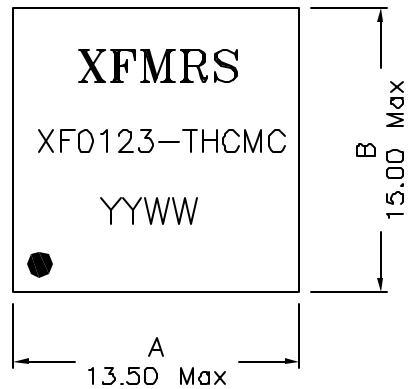
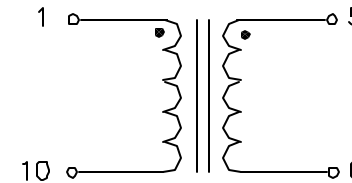

### 3. Electrical Specification: @25°C

OCL: 12mH+50/-30% @10KHz 50mV Each Wdg.

4.0mH Min @10KHz 50mV -40°C

Q: 15 Min @10KHz 50mV Each Wdg.

LL: Pins 1-10 75uH Max @10KHz 50mV Short Pins 5-6

Rated Voltage: 250VAC

Isolation Voltage: 1500VAC Wdg. to Wdg. for 2 Sec

DCR: 0.650 Ohms Typ Each Wdg.

Rated Current (For 40°C Rise Max): 0.3A Max

**Notes:**

1. Solderability: Leads shall meet MIL-STD-202G, Method 208H for solderability.
2. Flammability: UL94V-0
3. ASTM oxygen Index: > 28%
4. Insulation System: Class F 155°C. UL file E151556
5. All listed parameters are to be within tolerance from -40°C to +85°C unless otherwise noted.
6. Storage Temperature Range: -55°C to +125°C
7. Aqueous wash compatible
8. Electrical and mechanical specifications 100% tested
9. RoHS Compliant Component

Doc. Rev: A/6

<b>XFMRS Inc.</b> www.XFMRS.com	Title: Common Mode Choke		
	P/N: XF0123-THCMC		REV. A
UNLESS OTHERWISE SPECIFIED TOLERANCES: .xx ±0.25 Dimensions in MM	DWN.	Feng	Jul-06-11
	CHK.	YK Liao	Jul-06-11
SHEET 1 OF 1	APP.	Joe Huff	Jul-06-11