

1. Mechanical Dimensions:

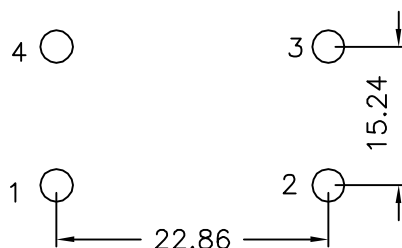

SUGGESTED FOOTPRINT

2. Schematic:

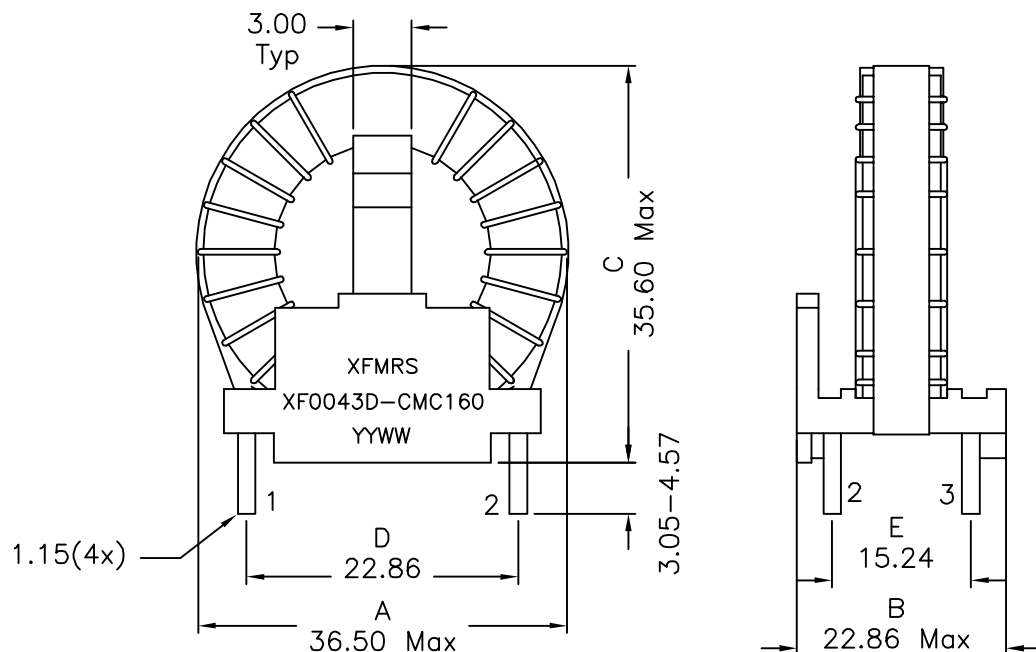
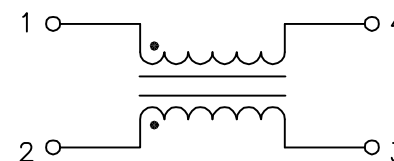

3. Electrical Specifications: @25°C

OCL: 4.0mH Min @15.75KHz 0.1V, Each Wdg

Q: 8 Min @15.75KHz 0.1V, Each Wdg

DCR: 0.026 Ohms Max, Each Wdg

LL: 65uH Max @100KHz 0.1V, Short Pins 2-3

Current Rating: 9.0Arms

Turn Ratio: (1-4):(2-3)=1:1±2%

Hipot: 1250Vac, Wdg to Wdg

SRF: Pins 1-4 200KHz Min

Notes:

1. Solderability: Leads shall meet MIL-STD-202, Method 208D for solderability.
2. Flammability: UL94V-0
3. ASTM oxygen index: > 28%
4. Insulation System: Class F 155°C. UL file E151556
5. Operating Temperature: -40°C to +85°C
6. Storage Temperature Range: -55°C to +125°C
7. Aqueous wash compatible
8. Electrical and mechanical specifications 100% tested
9. RoHS Compliant Component

XFMRS Inc www.XFMRS.com	Title: Common Mode Choke		
	UNLESS OTHERWISE SPECIFIED	P/N: XF0043D-CMC160	REV. A
TOLERANCES: .xx ±0.25	DWN.	Huo	Jun-29-18
Dimensions in mm	CHK.	YK Liao	Jun-29-18
SHEET 1 OF 2	APP.	DDC	Jun-29-18

DOC. REV: A/7

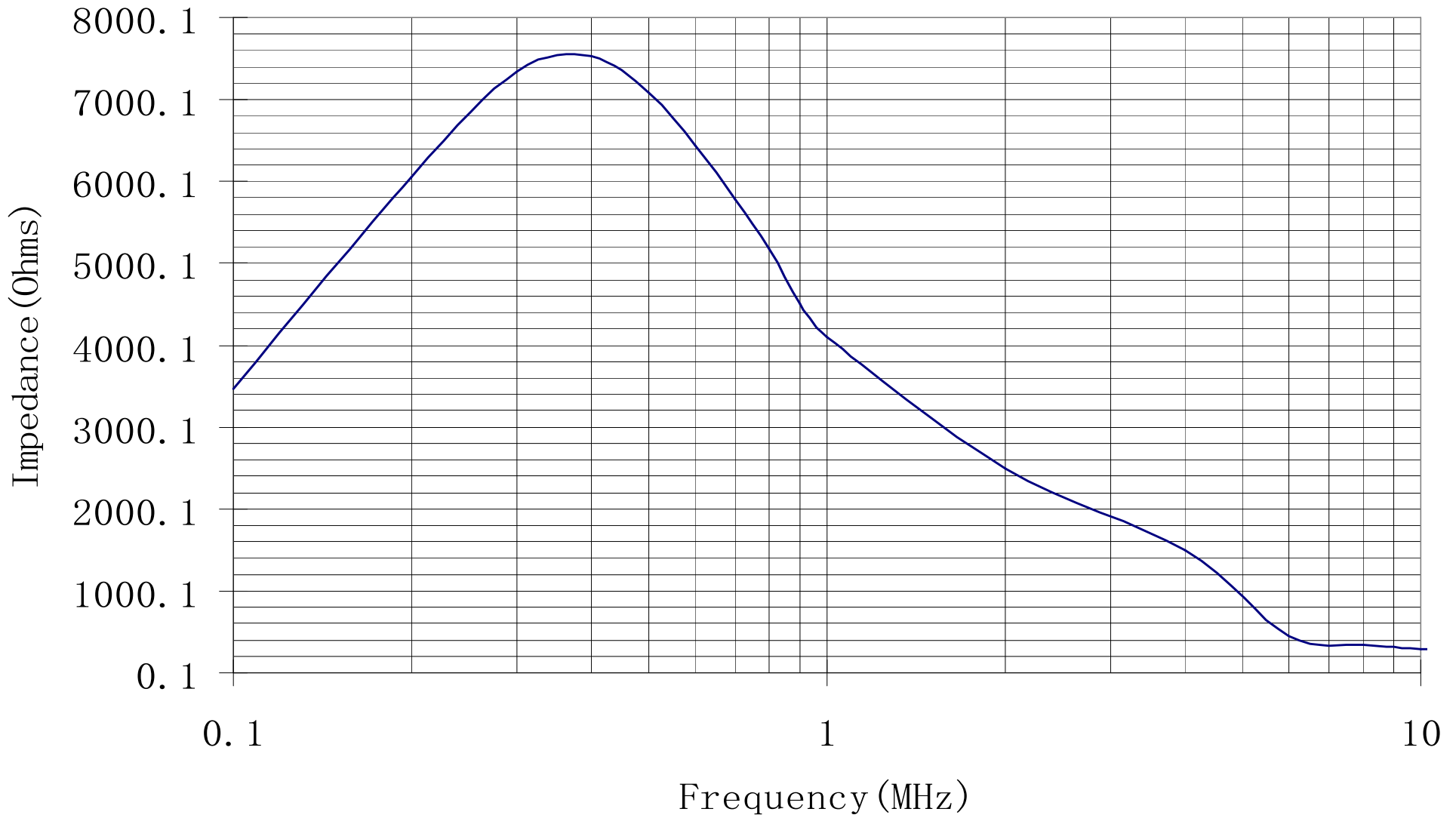

DOC. REV: A/7

XFMRs Inc www.XFMRS.com	Title: Common Mode Choke			
	UNLESS OTHERWISE SPECIFIED TOLERANCES: .xx ±0.25 Dimensions in mm	P/N: XF0043D-CMC160	REV. A	
	DWN.	Huo	Jun-29-18	
	CHK.	YK Liao	Jun-29-18	
SHEET 2 OF 2	APP.	DDC	Jun-29-18	

PROPRIETARY

Document is the property of XFMRs Group & is not allowed to be duplicated without authorization.