

1. Dimensions:

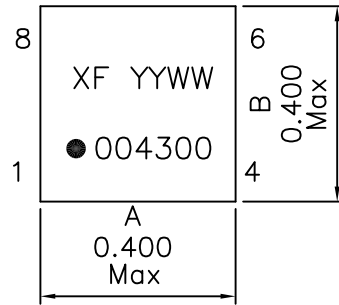

Dot Indicates PIN1

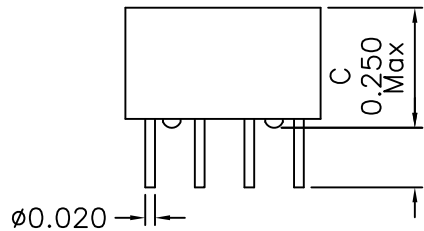
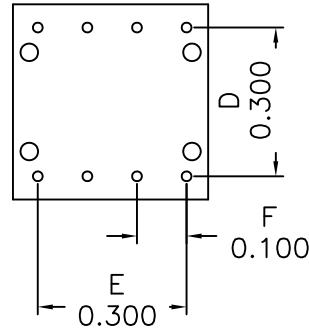

G
0.120±0.020

2. Schematic:

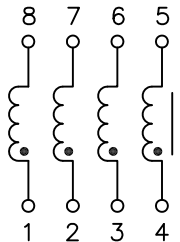

3. Electrical Specifications: @25°C

Isolation: 1000 Vrms

Turns Ratio: 1:1:1:1 ±5%

OCL: 4.0mH Minimum @10KHz 50mV

OCL: 1.8mH Minimum @10KHz 50mV at -40°C

Q : 12 Minimum @10KHz 50mV

Cw/w: 45.0pF Maximum @100KHz 50mV

Leakage Inductance: 1.00uH Max @100KHz 50mV

DC Resistance: 1.25 Ohms Maximum

Notes:

1. Solderability: Leads shall meet MIL-STD-202G, Method 208H for solderability.
2. Flammability: UL94V-0
3. ASTM oxygen index: > 28%
4. Insulation System: Class F 155°C. UL file E151556
5. All listed parameters are to be within tolerance from -40C to +85C unless otherwise noted.
6. Storage Temperature Range: -55°C to +125°C
7. Aqueous wash compatible
8. Electrical and mechanical specifications 100% tested
9. RoHS Compliant Component

XFMRs Inc.	Title: Common Mode Choke		
	UNLESS OTHERWISE SPECIFIED	P/N: XF0043-00	REV. A
	TOLERANCES: .xxx ±0.010	DWN.	Yuan Aug-30-13
	Dimensions in Inch	CHK.	YK Liao Aug-30-13
SCALE 2.5:1 SHT 1 OF 1	APP.	BSJ	Aug-30-13

DOC. REV A/1