

### 1. Mechanical Dimensions:

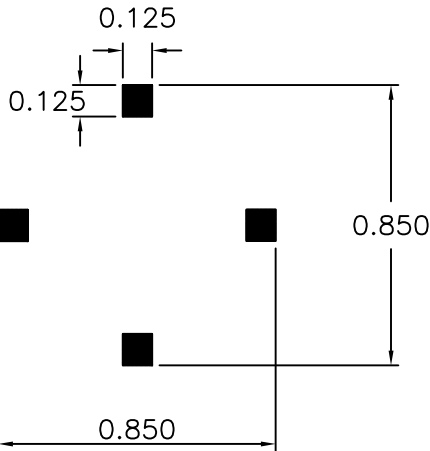

RECOMMENDED LAYOUT PATTERN  
(TOP VIEW)

### 2. Schematic:

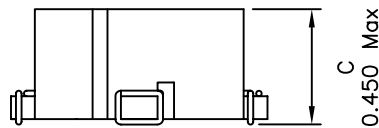
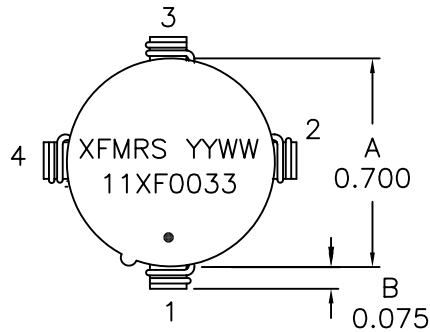
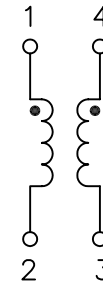

### 3. Electrical Specifications: @25°C

OCL: 3.3mH±30% @100KHz 0.1V, Each Wdg, 0°C to +105°C

0.5mH Min @100KHz 0.1V, Each Wdg, -55°C to 0°C

Q: Pins 1-2 1.5 Min @100KHz 0.1V

DCR: 0.055 Ohms Max, Each Wdg

Current Rating: 3.5Arms

Freq. Range: 300KHz - 20MHz @20dB Attenuation

Isolation Voltage: 500Vrms Wdg. to Wdg.

Notes:

1. Solderability: Leads shall meet MIL-STD-202G, Method 208H for solderability.
2. Flammability: UL94V-0
3. ASTM oxygen index: > 28%
4. Insulation System: Class F 155°C. UL file E151556
5. All listed parameters are to be within tolerance from -55°C to +105°C unless otherwise noted
6. Storage Temperature Range: -55°C to +125°C
7. Aqueous wash compatible
8. SMD Lead Coplanarity: ±0.004"(0.102mm)
9. Electrical and mechanical specifications 100% tested
10. RoHS Compliant Component

DOC REV: A/5

<b>XFMRS Inc</b> www.XFMRS.com		Title: <b>Common Mode Choke</b>	
UNLESS OTHERWISE SPECIFIED TOLERANCES: .xxx ±0.010 Dimensions in Inch	P/N: 11XF0033-CMC	REV. A	
	DWN.	Feng	Apr-01-11
SHT 1 OF 2	CHK.	YK Liao	Apr-01-11
	APP.	BW	Apr-01-11

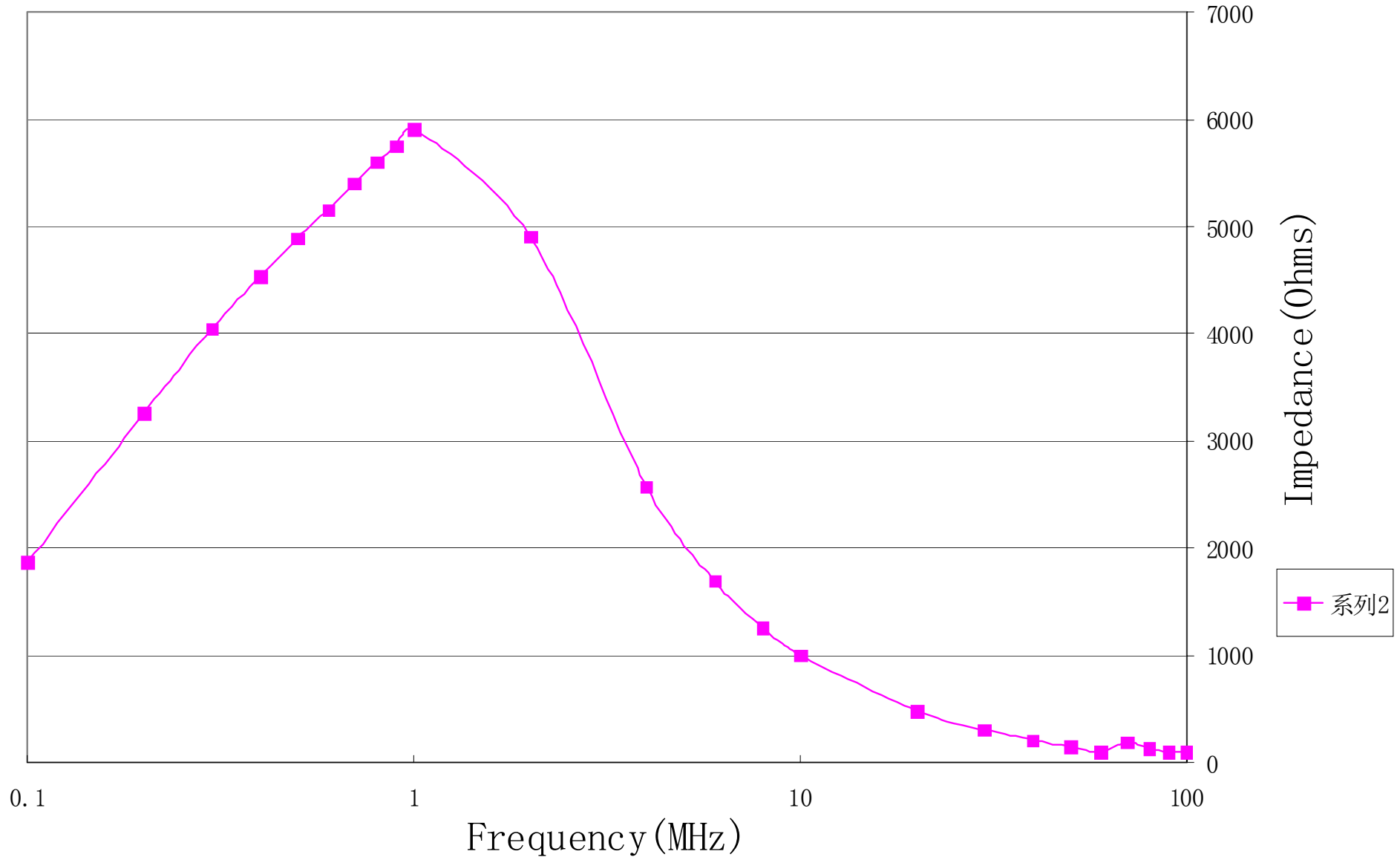

DOC REV: A/5

<b>XFMRs Inc</b> www.XFMRs.com	Title: <b>Common Mode Choke</b>		
	UNLESS OTHERWISE SPECIFIED TOLERANCES: .xxx ±0.010 Dimensions in Inch		P/N: 11XF0033-CMC
SHT 2 OF 2	DWN.	Feng	Apr-01-11
	CHK.	YK Liao	Apr-01-11
	APP.	BW	Apr-01-11

**PROPRIETARY**

Document is the property of XFMRs Group & is not allowed to be duplicated without authorization.