

### 1. Mechanical Dimensions:

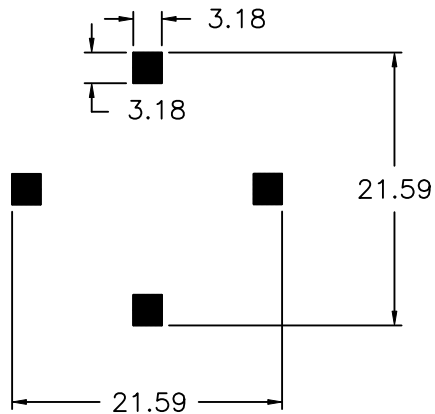

RECOMMENDED LAYOUT PATTERN  
(TOP VIEW)

### 2. Schematic:

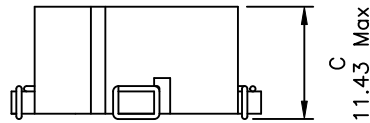
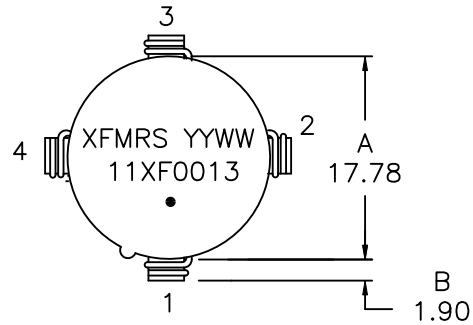
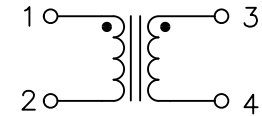

### 3. Electrical Specifications: @25°C

- OCL: 1.00mH ±25% @100KHz 1V, Each Wdg  
0.75mH Min @100KHz 1V, 15mAdc, Each Wdg
- Q: 15 Min @100KHz 1V, Each Wdg
- LL: Pins 1-2 12.0uH±10% @100KHz 1V, Short P3+4
- Cw/w: Pins 1-3 30pF Max @100KHz 1V
- DCR: 0.20 Ohms Max, Each Wdg
- Turns Ratio: (1-2):(3-4)=1:1±2%
- HIPOT: 3750Vac, 1Sec Wdg to Wdg  
or 3000Vac, 5Sec Wdg to Wdg

Notes:

1. Solderability: Leads shall meet MIL-STD-202G, Method 208H for solderability.
2. Flammability: UL94V-0
3. ASTM oxygen index: > 28%
4. Insulation System: Class F 155°C. UL file E151556
5. Operating Temperature Range: -40°C to +85°C
6. Storage Temperature Range: -40°C to +105°C
7. Aqueous wash compatible
8. SMD Lead Coplanarity: ±0.004"(0.102mm)
9. Electrical and mechanical specifications 100% tested
10. RoHS Compliant Component
11. Recommended IR Reflow peak temp of 235°C Max.

DOC REV: B/1

|  |  |         |           |
|--|--|---------|-----------|
| <b>XFMR5®</b><br><a href="http://www.XFMRS.com">www.XFMRS.com</a><br>UNLESS OTHERWISE SPECIFIED TOLERANCES:<br>.xx ±0.25<br>Dimensions in mm<br>SHEET 1 OF 1 | Title:<br><b>Power Line Coupling Transformer</b> |         |           |
|  | P/N: 11XF0013-PLC1                               |         | REV. B    |
|  | DWN.   | Yu      | Mar-29-21 |
|  | CHK.   | YK Liao | Mar-29-21 |
|  | APP.   | DDC     | Mar-29-21 |

# TAPE AND REEL SPECIFICATION:

## NOTES:

- 1) PROCESS IN ACCORDANCE WITH EIA-481-C STANDARDS
  - \* TAPE LEADER DIMENSION 15.30" MIN.
  - \* TAPE TRAILER DIMENSION 6.30" MIN.
- 2) PARTS SHOULD BE PACKAGED IN ACCORDANCE WITH ESD GUIDELINES IN EIA-541.
- 3) REEL LABEL: 'A' \* PART NUMBER
  - \* QUANTITY
  - \* DATE CODE
- 4) 180pcs PER 13" REEL

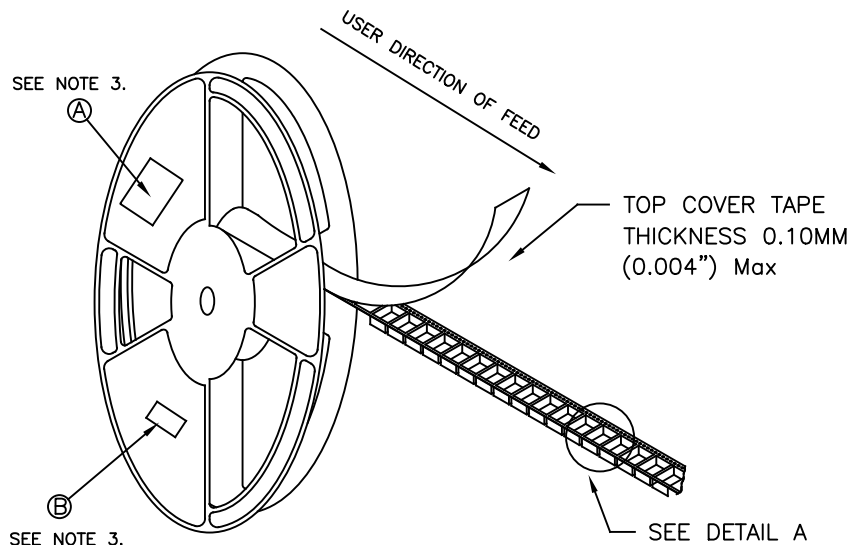

REEL AND TAPE ORIENTATION

## 13" REEL DIAMETER

DETAIL A

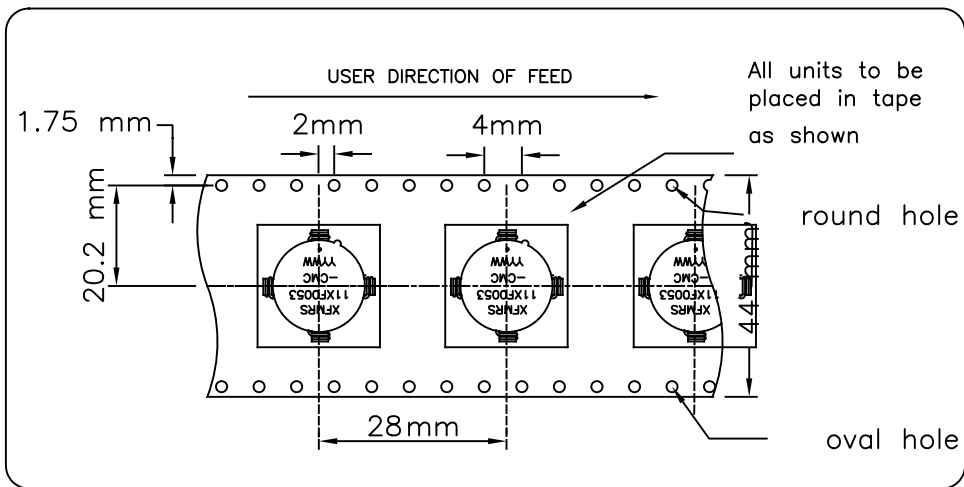

DOC REV:A/1

|                                   |  |                   |           |
|-----------------------------------|--|-------------------|-----------|
| <b>XFMRS Inc</b><br>www.XFMRS.com | Title: T&R SPEC  |                   |           |
|                                   | UNLESS OTHERWISE SPECIFIED<br>TOLERANCES:<br>.xxx ±xxxxx<br>Dimensions in mm | P/N: 11XF0053-CMC | REV: A    |
|                                   | DWN.   | Juan Mao          | Feb-16-06 |
|                                   | CHK.   | YK Liao           | Feb-16-06 |
| SHT 1 OF 1                        | APP.   | BW                | Feb-16-06 |

# XFMRs

## Recommended Infrared Reflow Temperature Profile for RoHS Compliant Parts

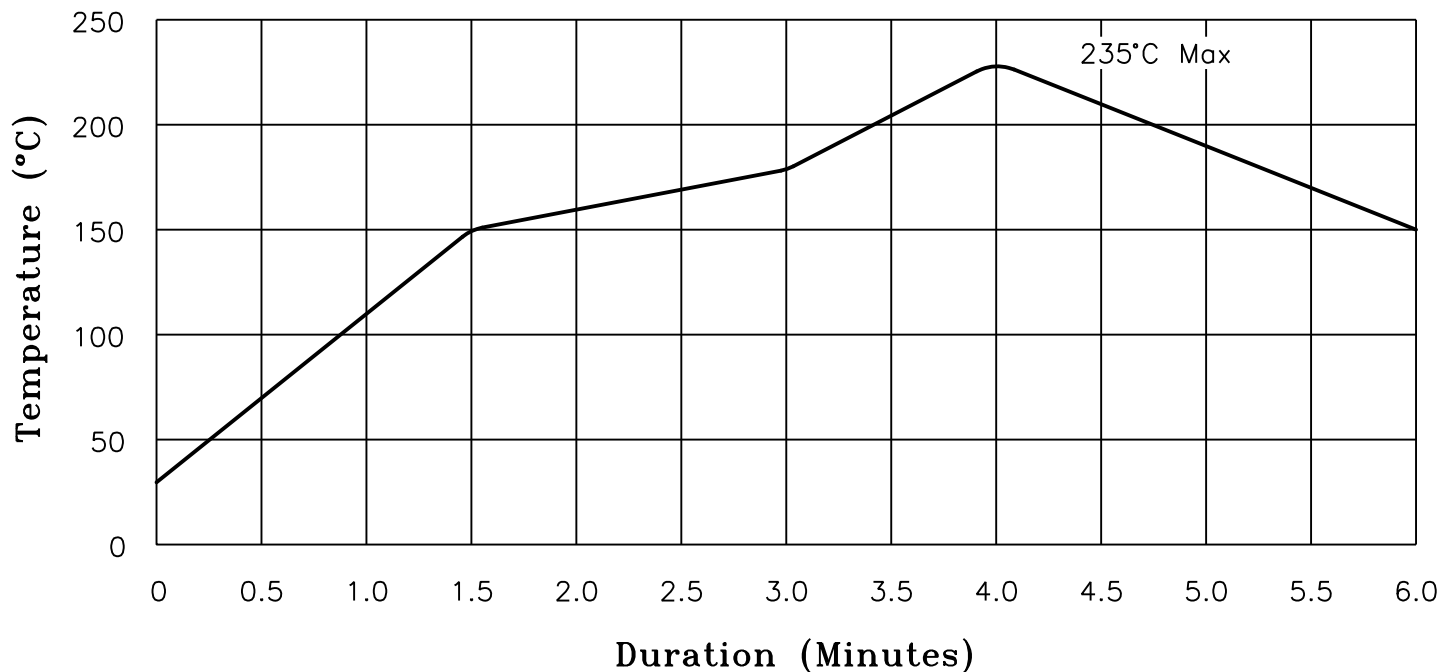

NOTES: Maximum duration at 235+0/-5° shall be 10-15 seconds.  
 Maximum duration above 217° shall be 45-75 seconds.  
 ALL Temperatures refer to topside of the package, measured on the package body surface.  
 \*Excludes ALL RJ-45 Combo products. (See IR Reflow for Non-RoHS Compliant parts)

|  |          |  |           |
|--|----------|--|-----------|
| <b>XFMRs Inc</b><br>www.XFMRs.com                |          | Title: <b>IR REFLOW CHART</b><br><b>(RoHS Compliant parts)</b> |           |
| UNLESS OTHERWISE SPECIFIED<br>TOLERANCES:<br>N/A | P/N: N/A |  | REV. A    |
|  | DWN.     | 廖玉坤  | Aug-18-05 |
|  | CHK.     | 李清儿  | Aug-18-05 |
| SHEET 1 OF 1                                     | APP.     | Isaiah M   | Aug-18-05 |