

1. Mechanical Dimensions:

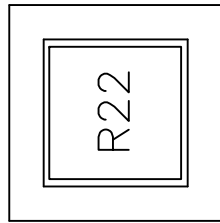

Top view

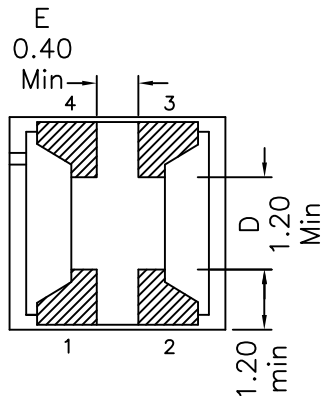
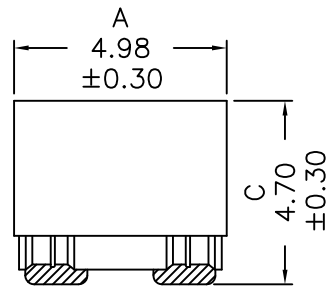
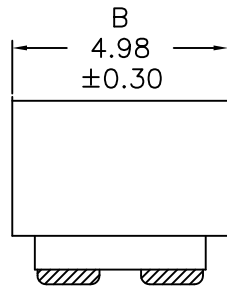

Bottom view

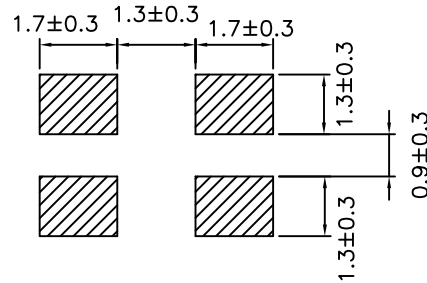

Suggested Pad Layout

2. Schematic:

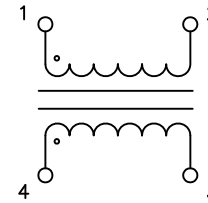

3. Electrical Specification: @25°C

OCL: 0.22uH Min @100KHz, 0.1V Each Wdg.

Q: 5 Min @100KHz, 0.1V Each Wdg.

Rated Current: 1.5A

DCR: 0.105 Ohms Max Each Wdg.

Insertion Loss (dB) common mode/differential mode:

| 100MHz | 200MHz | 400MHz | 500MHz |
|-----------|------------|------------|------------|
| 9.04/0.19 | 13.66/0.94 | 17.75/1.79 | 17.11/2.09 |

Notes:

- Solderability: Leads shall meet MIL-STD-202G, Method 208H for solderability.
- Flammability: UL94V-0
- ASTM oxygen index: > 28%
- Insulation System: Class F 155°C. UL file E151556
- All listed parameters are to be within tolerance from -40°C to +85°C unless otherwise noted
- Storage Temperature Range: -55°C to +125°C
- Aqueous wash compatible
- SMD Lead Coplanarity: ±0.004"(0.102mm)
- Electrical and mechanical specifications 100% tested
- RoHS Compliant Component
- Recommended IR Reflow peak temp of 250°C Max.

| | | | |
|------------------------------------|--|-----------------------|-----------|
| XFMRs Inc. www.XFMRs.com | Title: EMI filter | | |
| | UNLESS OTHERWISE SPECIFIED TOLERANCES: .xx ±0.25 Dimensions in MM | P/N: XFWCMC636347-R22 | Rev. A |
| SHT 1 OF 2 | DWN. | Yuan | Jan-09-15 |
| | CHK. | YK Liao | Jan-09-15 |
| | APP. | BW | Jan-09-15 |

DOC. REV: A/6

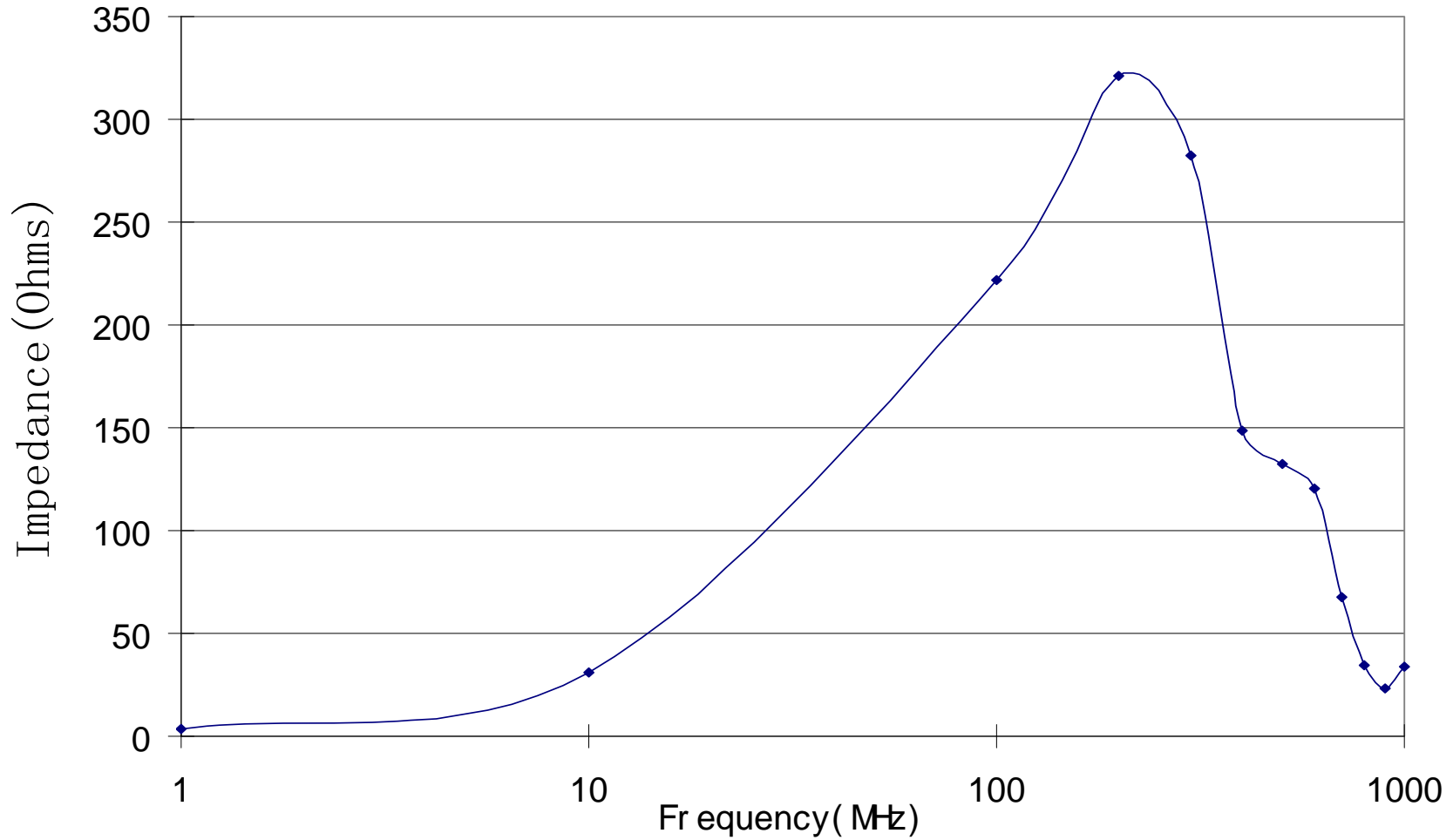

DOC. REV: A/6

| | | | |
|------------------------------------|---|---------|-----------------------|
| XFMRs Inc. www.XFMRS.com | Title: EMI filter | | |
| | UNLESS OTHERWISE SPECIFIED TOLERANCES: .xx ±0.25 Dimensions in MM | | P/N: XFWCMC636347-R22 |
| SHT 2 OF 2 | DWN. | Yuan | Jan-09-15 |
| | CHK. | YK Liao | Jan-09-15 |
| | APP. | BW | Jan-09-15 |

PROPRIETARY

Document is the property of XFMRs Group & is not allowed to be duplicated without authorization.