

1. Mechanical Dimensions:

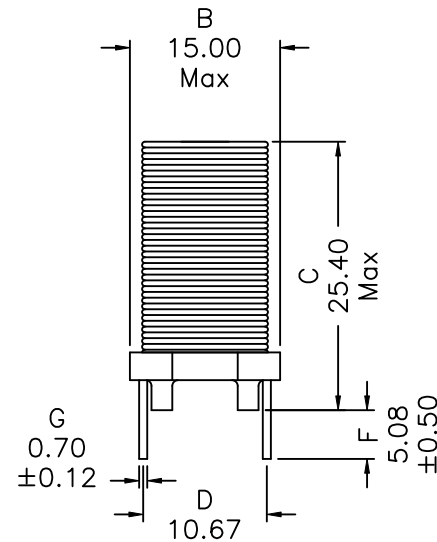

2. Schematic:

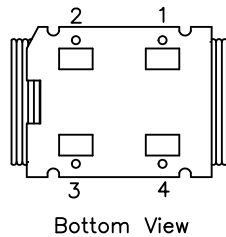
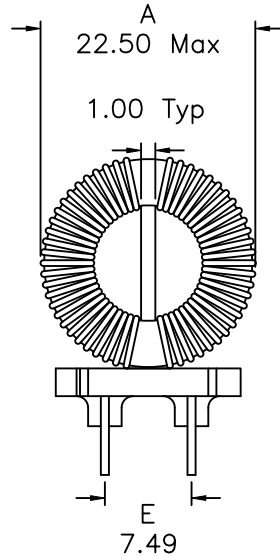
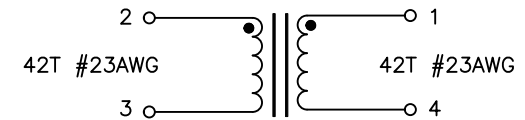

Core: ACME A05 T18*10*10C

3. Electrical Specifications: @25C

OCL: 10.0mH±30% @10KHz 0.1V, Each Wdg

Q: 90 Min @10KHz 0.1V, Each Wdg

DCR: 125mOhms Max, Each Wdg

Rated Current: 2.0A

Turns Ratio: (1-4):(2-3)=1:1±2%

Hipot: 1500Vac, Wdg to Wdg

SRF: Pins 1-4 100KHz Min

Notes:

1. Solderability: Leads shall meet MIL-STD-202G, Method 208H for solderability.
2. Flammability: UL94V-0
3. ASTM oxygen index: > 28%
4. Insulation System: Class F 155°C. UL file E151556
5. Operating temperature Range: -40°C to +125°C
6. Storage Temperature Range: -55°C to +125°C
7. Aqueous wash compatible
8. Electrical and mechanical specifications 100% tested
9. RoHS Compliant Component

DOC REV: A/2

XFMRs® www.XFMRS.com	Title: COMMON MODE CHOKE		
	UNLESS OTHERWISE SPECIFIED TOLERANCES: .xx ±0.25 Dimensions in mm	P/N: XF0103-VMCMC5	REV. A
SHEET 1 OF 2	DWN.	Yu	May-25-21
	CHK.	YK Liao	May-25-21
	APP.	BW	May-25-21

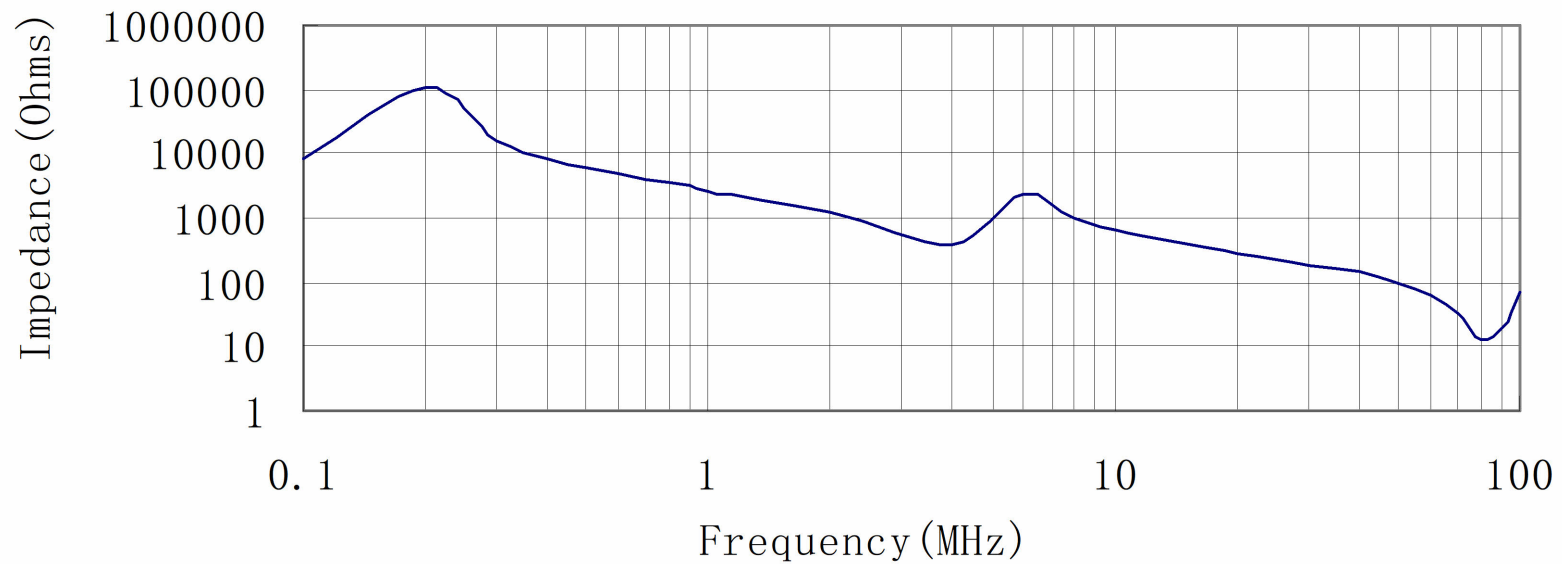

DOC REV: A/2

XFMRs® www.XFMRs.com	Title: COMMON MODE CHOKE		
	UNLESS OTHERWISE SPECIFIED TOLERANCES: .xx ±0.25 Dimensions in mm		P/N: XF0103-VMCMC5 REV. A
SHEET 2 OF 2	DWN.	Yu	May-25-21
	CHK.	YK Liao	May-25-21
	APP.	BW	May-25-21