

1. Mechanical Dimensions:

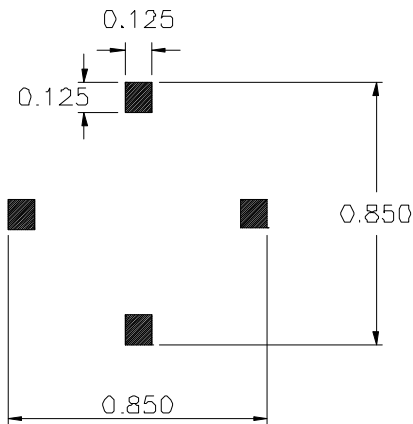

RECOMMENDED LAYOUT PATTERN
(TOP VIEW)

2. Schematic:

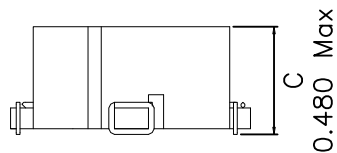
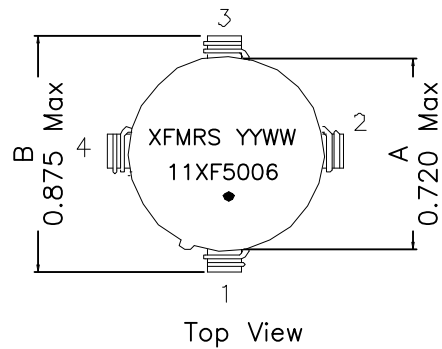
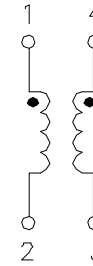

3. Electrical Specifications: @25°C

OCL: 500uH Min @1KHz 50mV, Each

DCR: 0.010 Ohms Max, Each

Current Rating: 6.0Arms

Hipot: 500Vac, Wdg to Wdg

Turns Ratio: (1-2):(4-3)=1.000:1.000±2%

Q: Pins 1-2 5 Min @10KHz 0.1V

SRF: Pins 1-2 2MHz Min

Notes:

1. Solderability: Leads shall meet MIL-STD-202G, Method 208H for solderability.
2. Flammability: UL94V-0
3. ASTM oxygen index: > 28%
4. Insulation System: Class F 155°C. UL file E151556
5. Operating Temperature Range: -55°C to +105°C
6. Storage Temperature Range: -55°C to +125°C
7. Aqueous wash compatible
8. SMD Lead Coplanarity: ±0.004*(0.102mm)
9. Electrical and mechanical specifications 100% tested
10. RoHS Compliant Component
11. Recommended IR Reflow peak temp of 250°C Max.

XFMRS® www.XFMRS.com	Title: Common Mode Choke		
	UNLESS OTHERWISE SPECIFIED TOLERANCES: .xxx ±0.010 Dimensions in mm	P/N: 11XF5006-CMC	REV. A
SHEET 1 OF 2	DWN.	Yu	Apr-30-24
	CHK.	YK Liao	Apr-30-24
	APP.	Joe Huff	Apr-30-24

DOC. REV: A/4

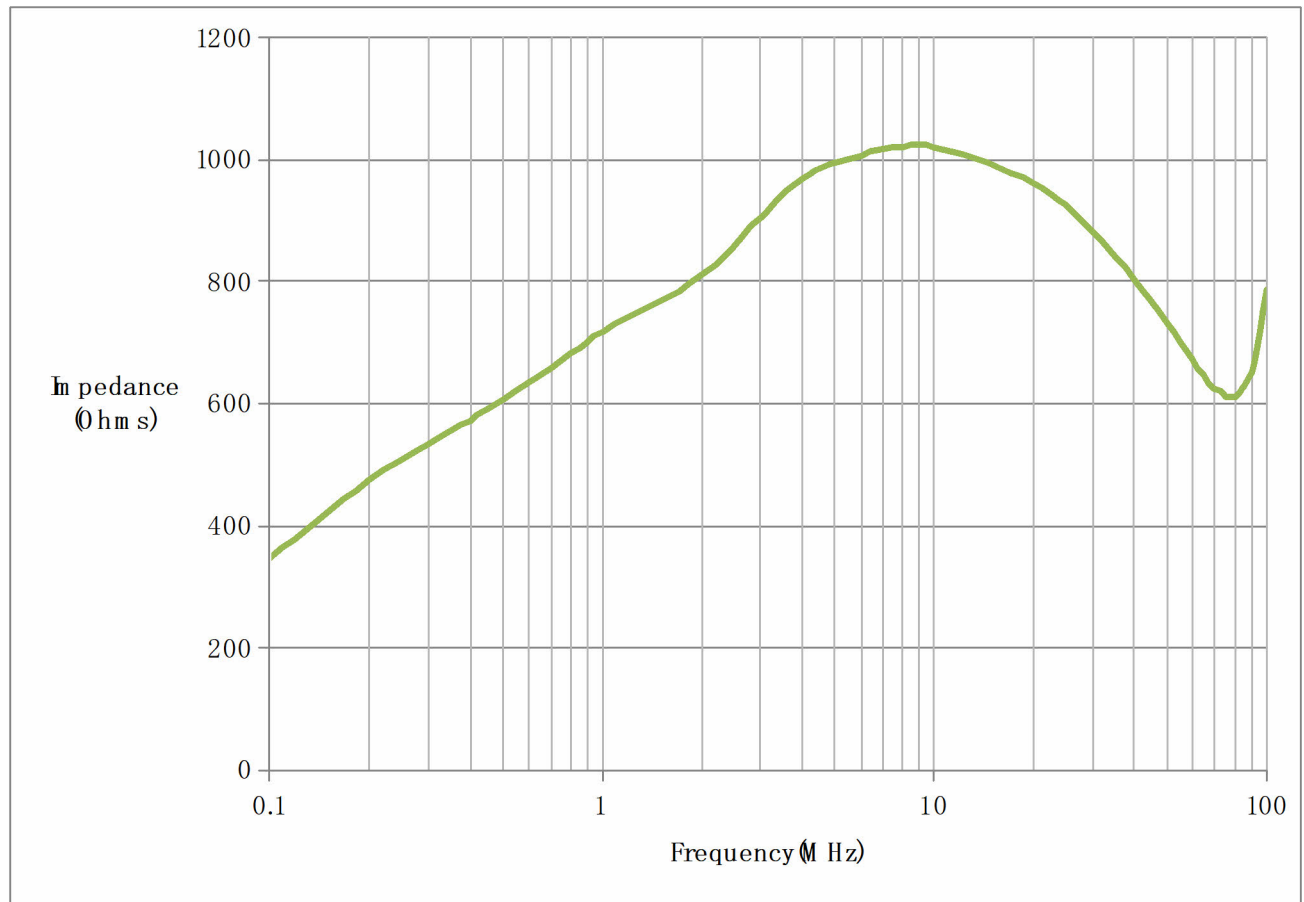

DOC. REV: A/4

XFMRs® www.XFMRS.com		Title: Common Mode Choke	
UNLESS OTHERWISE SPECIFIED TOLERANCES: .xxx ±0.010 Dimensions in mm		P/N: 11XF5006-CMC	
		REV. A	
SHEET 2 OF 2		DWN.	Yu
		CHK.	YK Liao
		APP.	Joe Huff
			Apr-30-24